

# INSTALL WEIGHT STACK SHROUDS

***Bolts in the Top Frame may need to be loosened to install Stack Shrouds.***

1. Attach Weight Stack Shroud (201) and Weight Stack Shroud with Number (202) to the tabs welded on Base Frame (1) and Top Frame (2) as shown, using four 5/16" X 1/2" Round Bolts (89) and four 5/16" Washers (102).

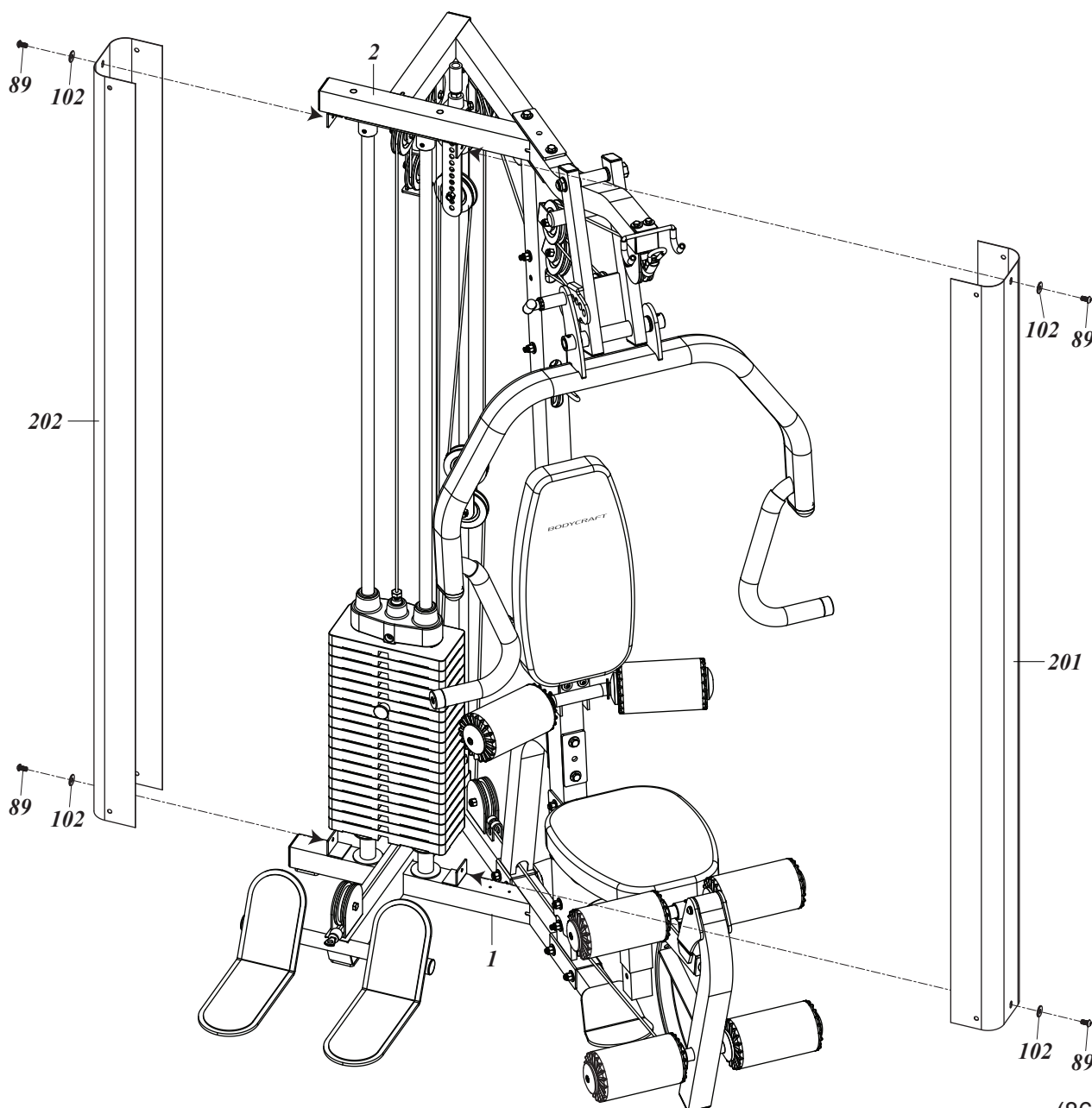
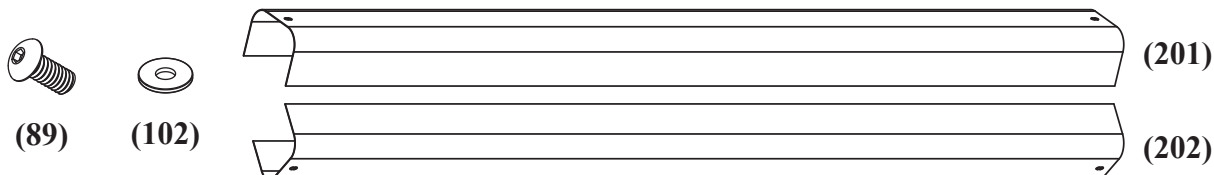

(868F)CV