

BODYCRAFT

Leg Press Option

for the BODYCRAFT GT / GTX (Strength Training System)

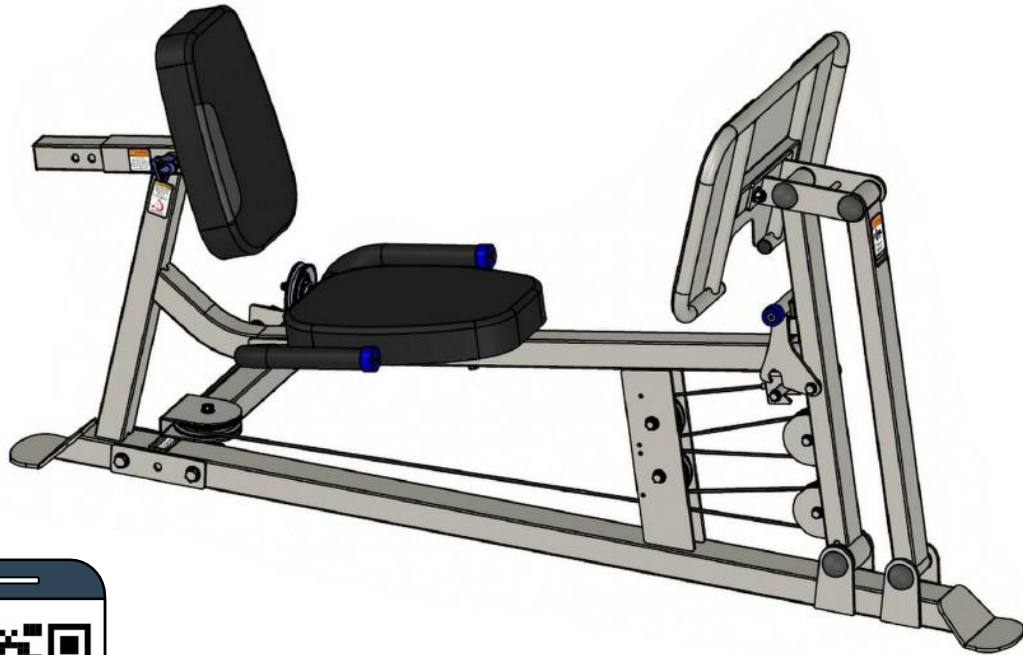

To see in
FULL COLOR
& additional information,
scan this QR code.

US Patent # 10,821,316

Base Serial Number: _____
Purchased Date: ____ / ____ / ____
Dealer's Name: _____
Please register your products at:
<https://www.bodycraft.com/product-registration/>



Owner's Manual

GT-X-LP v1.3



WWW.BODYCRAFT.COM



800-990-5556



SERVICE@BODYCRAFT.COM

This page intentionally left blank

Congratulations and Welcome to the BODYCRAFT Family

Thank you for selecting BODYCRAFT. Your choice reflects a wise investment in you and your facility. We hope you use it for many healthy years!

BODYCRAFT offers a complete array of high-quality fitness equipment. Please refer to our website at www.bodycraft.com to view more ways to enhance your lifestyle.

Your BODYCRAFT machine has all the quality and design elements to make your workout extremely efficient and comfortable. Your new unit is a serious strength training machine that will keep you motivated, challenged and within reach of your fitness goals. Strength & cardiovascular training is vital for all ages which will provide an effective workout, producing results that will encourage you to reach your fitness goals and maintain the body you have always wanted.

Spending 15 to 30 minutes a day, three times a week, is all you need to start seeing the benefits of a regular exercise program.

As a premium exercise equipment manufacturer, we are committed to your complete satisfaction. If you have questions, suggestions or find missing or damaged parts, we guarantee your complete satisfaction through our authorized dealer network or by contacting us directly. Please call your local dealer or BODYCRAFT.

BODYCRAFT (a division of Recreation Supply, Inc.)
7699 Green Meadows Dr.
Lewis Center, OH 43035

Phone: 800-990-5556 9 am - 5 pm EST **Email:** service@bodycraft.com

Proof of purchase must be supplied to validate warranty and the product must have been registered with BODYCRAFT via online at www.bodycraft.com or by calling 800-990-5556 or 740-965-2442 M-F 9 a.m. - 5 p.m. EST.

For parts orders, owner's manuals, software update files, exercise guides and contact information scan this QR code.

Or go to:

<https://www.bodycraft.com/customer-support>

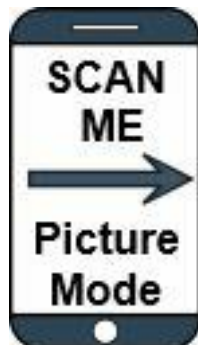



NOTE: When you have downloaded the Owner's Manual into a PDF reader, go directly to the desired page by touching words in this Table of Contents.

Product Safety Information	Page
Product Safety	5
Important Notes, Recommended Tools & Cleaners	6
Warning Labels, Serial Number Placements.....	7
 Product Overview	
Machine Dimensions, Room Layouts & Weight Ratios.....	8
Assembly Parts List	9
Assembly Parts Hardware	10
Shipping Box & What's Inside	11
 Product Assembly - How to Assemble the GT-Leg Press	
Pre-Assembly Tips	12
STEP 1a thru STEP 3b - Main Assembly Procedures	13
STEP 4a thru 5 - Leg Press Cable Assembly & "Torque Time"	20
STEP 6a thru 6b - Assembly Domed Caps & Adj. the Cable	28
STEP 7 - Final Assembly Clean Up, Polish & Double Checks	29
 Maintenance & Repairs	
Detailed Parts List	30 - 31
Detailed Parts Exploded View	32
Required Info BEFORE Initiating a Service Case	33
 Warranty	
Product Warranty	34
Product Warranty Registration	35
Contact Us Information	36

Product Safety - Functional Trainer & Multi-Gym



There is a risk assumed by individuals who use this type of equipment. A moment's lack of attention can result in an accident, as can failure to observe certain simple safety precautions.

Read, study and understand the Assembly Instructions and all the warning labels on this product. Furthermore, it is recommended to familiarize yourself and others with the proper operation and workout recommendations for this BODYCRAFT product prior to use.

- Before beginning this or any other exercise program, consult your physician. This is especially important for individuals over the age of 35 or persons with preexisting health problems. Recreation Supply, Inc. assumes no responsibility for personal injury or property damage sustained by or through use of this product.
 - Exercise with care to avoid injury. Do not attempt to lift more weight than you can control safely.
 - This product must be assembled on a flat, level surface to assure its proper function.
 - Clean pads and frame on a regular basis. We recommend warm, soapy water. Do not use harsh or abrasive chemicals.
 - Inspect and tighten all parts before every use. Replace any worn parts immediately. Failure to do so may result in serious injury.
 - Keep children away from any BODYCRAFT strength machines at all times.
 - Keep your hands away from cables and pulleys during operation, other than the designated handles.
- 
- Keep hands, limbs, loose clothing and long hair well out of the way of moving parts.
 - Make certain all cables are seated within the pulleys before every use. Frayed or worn cables can be dangerous and may cause injury. Periodically check the cable for any indication of wear.
 - Inspect the unit for any sign of wear on parts, hardware becoming loose or cracks on welds. If a problem is found, do not use or allow the machine to be used until the defective part is repaired or replaced.
 - It is imperative that you retain this Assembly Instructions and be sure all warning labels are legible and intact. Replacement Assembly Instructions and labels are available from BODYCRAFT. If you are unsure about the proper use of the BODYCRAFT strength machine call your local BODYCRAFT dealer or our Customer Service Department. Contact BODYCRAFT at 800-990-5556 or support@bodycraft.com

Important Notes, Recommended Tools & Cleaners , GT-LP (Leg Press)

Important Notes and Tips:

1. Before assembly, read all instructions thoroughly and preview diagrams to help make the installation easier.
2. Make sure all parts are accounted for and in proper condition before beginning assembly. See the parts list.
3. Be cautious not to damage the flooring when assembling. Place a protectant down such as a rubber mat or shipping blanket.
4. Let plastics and weight stacks acclimate to room temperature before you begin assembly.
5. Two people are recommended for the safe assembly of this equipment.
6. Insert all bolts in the same direction when possible. Do not tighten until instructed.
7. Carefully install plastic caps using a rubber mallet.
8. When measuring bolt lengths, only measure the shank.
9. When the installation is complete, be sure to regularly check for rust or damage, and perform preventative maintenance.

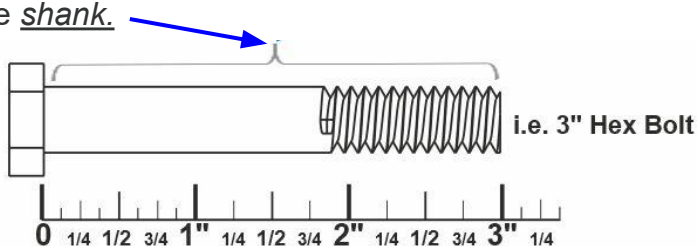

THE FOLLOWING TOOLS ARE RECOMMENDED FOR ASSEMBLY:



SOCKET SET 3/8 DRIVE & 6" EXT
(Only 9/16 & 3/4 Sockets are needed)



OPEN, CLOSED & ADJUSTABLE WRENCHES
(Only 9/16 & 3/4 are needed)



TORQUE WRENCH
3/8 DRIVE
(w/ 5/16" Hex Bit Socket)



RUBBER Mallet & ALLEN WRENCH SET
(Only 5/16" is needed)

THE FOLLOWING IS RECOMMENDED FOR CLEANING:



MILD CLEANING SOLUTION



100% COTTON CLEANING CLOTHS

TIP ON FRAME ONLY: For extra protection from fingerprints, sweat stains or just plain dirt, apply an automotive grade cleaner wax if desired. Also makes future cleaning easier.

(Do Not Use on the Upholstery)



Carefully read ALL Warning, Caution & Maintenance Schedule labels



(255)



(256)



(257)



(258)



(258)

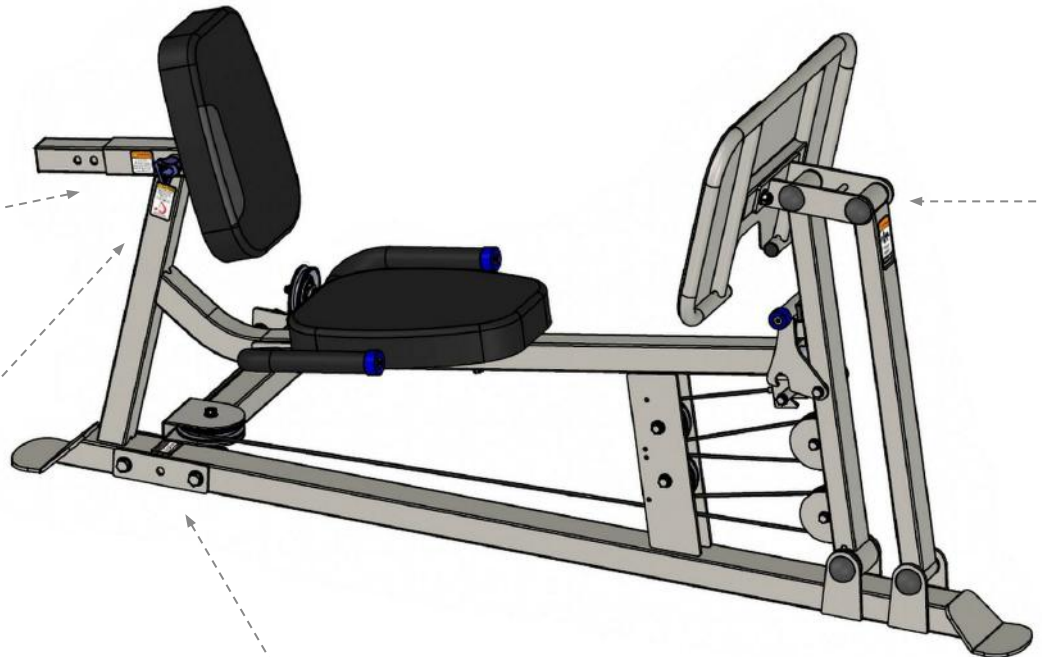

(255)

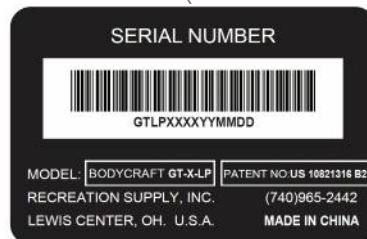

(257)



(256)

Machine Dimensions, Room Layouts, & Weight Ratios, GT-LP (Leg Press)

Your BODYCRAFT GT Strength Training System with Options was designed to be placed in a corner.

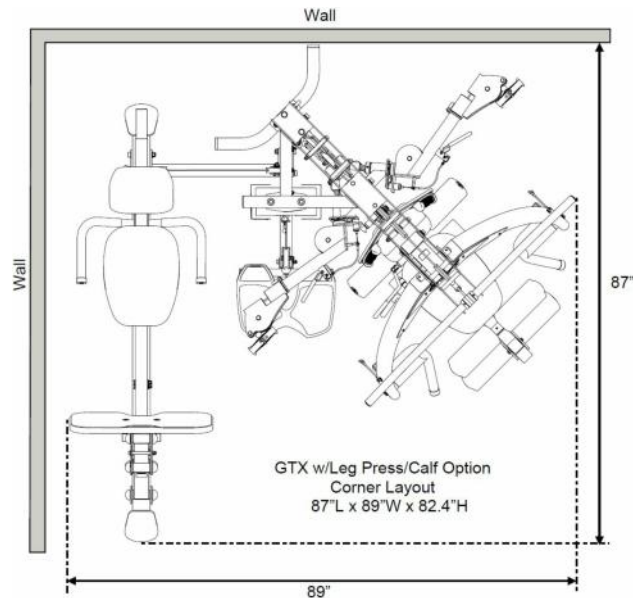
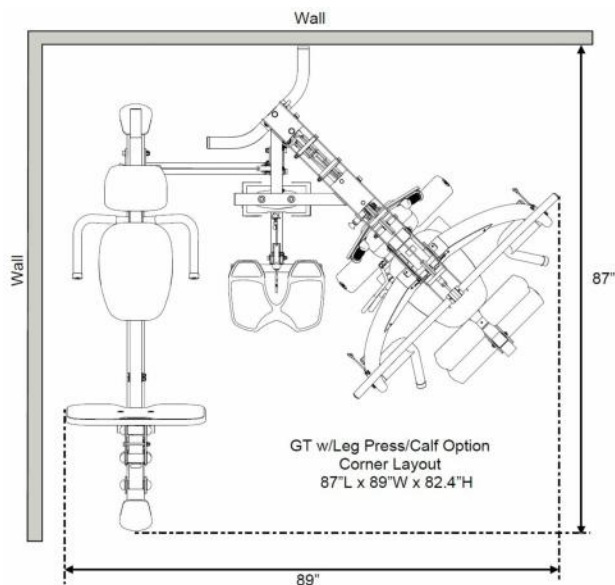

For ADA Compliance under #1004 Exercise Machines and Equipment:

Minimum of 36" for entry, use & exit of machine required. Add up to 36" in the Training Area where needed.

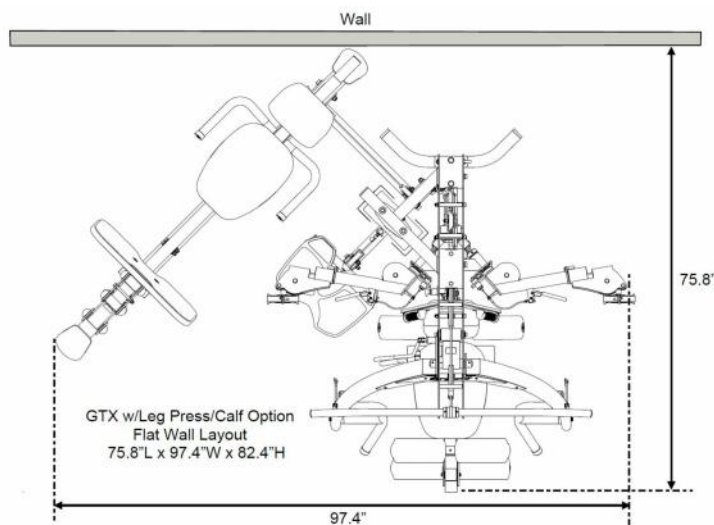
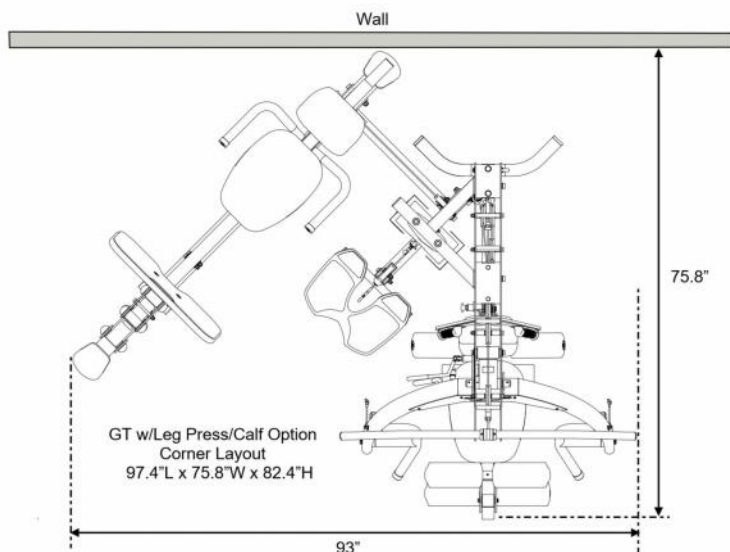
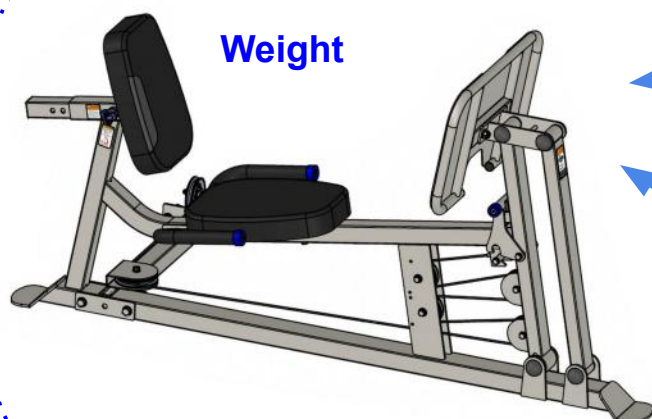

Part #	Assembly Parts List	QTY
GT-X-LP-201	Frame, Connecting to GT-X base unit	1
GT-X-LP-202-ASM	Frame, Main Base - Assembly	1
GT-X-LP-203-ASM	Leg Press Support, Rear - Assembly	1
GT-X-LP-204-ASM	Frame, Seat Handle - Assembly	1
GT-X-LP-205-ASM	Back Pad Adjuster - Assembly	1
GT-X-LP-206-ASM	Foot Plate, with Black Diamond Plate - Assembly	1
GT-X-LP-207-ASM	Leg Press Support, Front - Assembly	1
GT-X-LP-208	Leg Press Upper Connector	1
GT-X-LP-209	Axle, w/ one side flat notch , 25mm OD x 1/2" ID threaded x 90mm L	4
GT-X-LP-210-ASM	Hook, for Turbo Feature - Assembly	1
GT-X-LP-211	Spacer, for Inner Side of Bottom Axle in the Rear Leg Support Frame	2
GT-X-LP-212	Spacer, 10.5mm OD x 16mm ID x 46mm L - Chrome	2
GT-X-LP-213	Bushing, Plastic, for Pulley to Frame	4
GT-X-LP-215	Pad, Back for Leg Press	1
GT-X-LP-216	Pad, Seat for Leg Press	1
GT-X-LP-217	Cable, Leg Press, 4,850mm (191")	1
GT-X-LP-220	Pull-Pin Locking Knob, Aluminum - BLUE	1
GT-X-LP-221-ASM	Adjustable Stopper, between Top Connector Frame & Single Block Pulley - Assembly	1
GT-X-LP-223	Cap, Plastic, Domed for 1/2" Bolt & Nut Ends	8
GT-X-LP-227	Pulley, 90mm (3-1/2") x 526mm ID	5
GT-X-LP-228	Pulley, 114mm (4-1/2") x 526mm ID	1
GT-X-LP-260	Poster - Exercise Guide	1

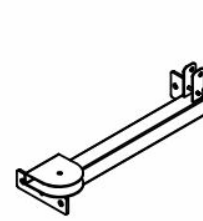

(201)



(203-ASM)

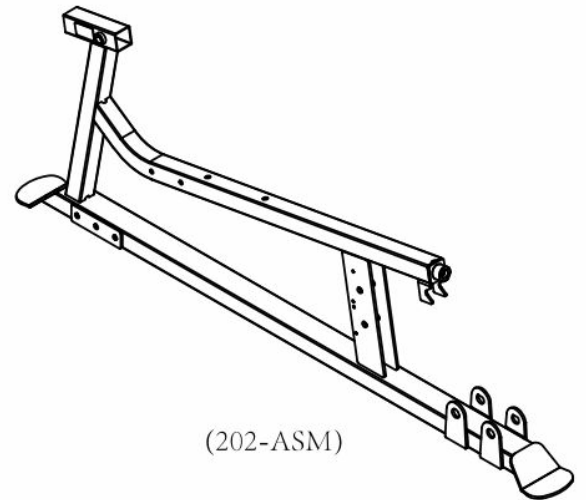

(202-ASM)



(204-ASM)



(205-ASM)

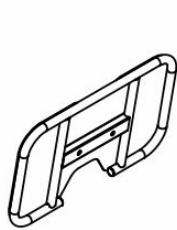

(206-ASM)



(207-ASM)



(208)



(209)



(210-ASM)



(211)



(212)



(213)



(215)

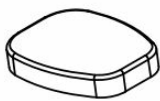

(216)

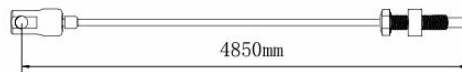

(217)



(220)



(221-ASM)



(223)



(227)



(228)



(260)

NOTE: Parts are not to scale

Part #	Assembly Hardware	QTY
GT-X-LP-232	Bolt, Hex Head, 3/8" x 1" L - BLK	1
GT-X-LP-233	Bolt, Hex Head, 3/8" x 1-1/4" L - BLK	2
GT-X-LP-234	Bolt, Hex Head, 3/8" x 2" L - BLK	4
GT-X-LP-235	Bolt, Hex Head, 3/8" x 2-7/8" L - BLK	6
GT-X-LP-236	Bolt, Hex Head, 3/8" x 4-1/4" L - BLK	1
GT-X-LP-237	Bolt, Hex Head, 3/8" x 5" L - BLK	1
GT-X-LP-238	Bolt, Hex Head, 1/2" x 1" L - BLK	8
GT-X-LP-239	Bolt, Hex Head, 1/2" x 3-1/8" L - BLK	2
GT-X-LP-240	Bolt, Hex Head, 1/2" x 4-1/8" L - BLK	2
GT-X-LP-242	Bolt, Recessed Countersunk Head, 1/2" x 2" L - BLK	2
GT-X-LP-245	Washer, Flat, 3/8" - BLK	24
GT-X-LP-246	Washer, Flat, 1/2" - BLK	9
GT-X-LP-247	Washer, Flat, Large, φ12 - BLK	8
GT-X-LP-249	Washer, Spring, 3/8" - BLK	6
GT-X-LP-250	Washer, Spring, 1/2" - BLK	9
GT-X-LP-251	Nut, Nylon Lock, 3/8" - BLK	9
GT-X-LP-252	Nut, Nylon Lock, 1/2" - BLK	5
GT-X-LP-259	Wrench, Hex 5/16"	1

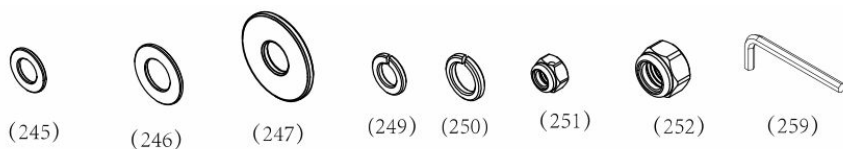
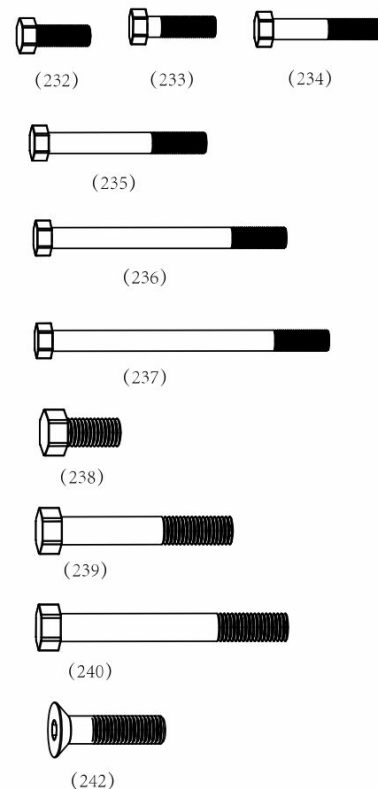

NOTE: Parts are not to scale

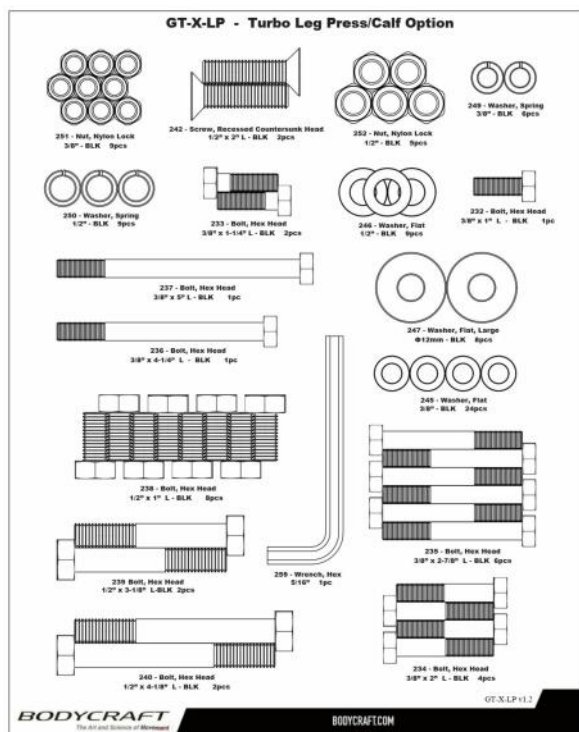

Hardware Kit

Comes inside Box #1



Owner's Manual

Comes inside Box #1

PREASSEMBLY TIP #1 – “Stage Right”.

During the assembly process we will be stating Right, Left, Front, Back, Top, or Bottom. These all are in the perspective of the user in the machine facing outward with feet on the ground.

See below images as examples.



STAGE RIGHT DEFINITION: Both “Stage Right” or “Stage Left” are from the viewpoint of the actor facing outward from the stage.



PREASSEMBLY TIP #2 – Unpackaging & organizing.

The best practice in assembly is to take all the parts out of the boxes & bags and line up in order of assembly. This enables a mindset of what you will be assembling, their physical sizes and what challenges you might face BEFORE you begin.



PREASSEMBLY TIP #3 – Keep hardware loose until asked to tighten.

During the assembly, hardware needs to be finger tight until the STEPS of “Torque Time”. This will ensure sub-frame and other parts will easily fit together and not strip out bolt threads during assembly.

Product Assembly, GT-LP (Leg Press), STEP 1a - 1b



Please Hand Tighten All Nuts & Bolts Until STEP 2f



STEP 1a - 1b: Install Connecting Frame and Main Frame.

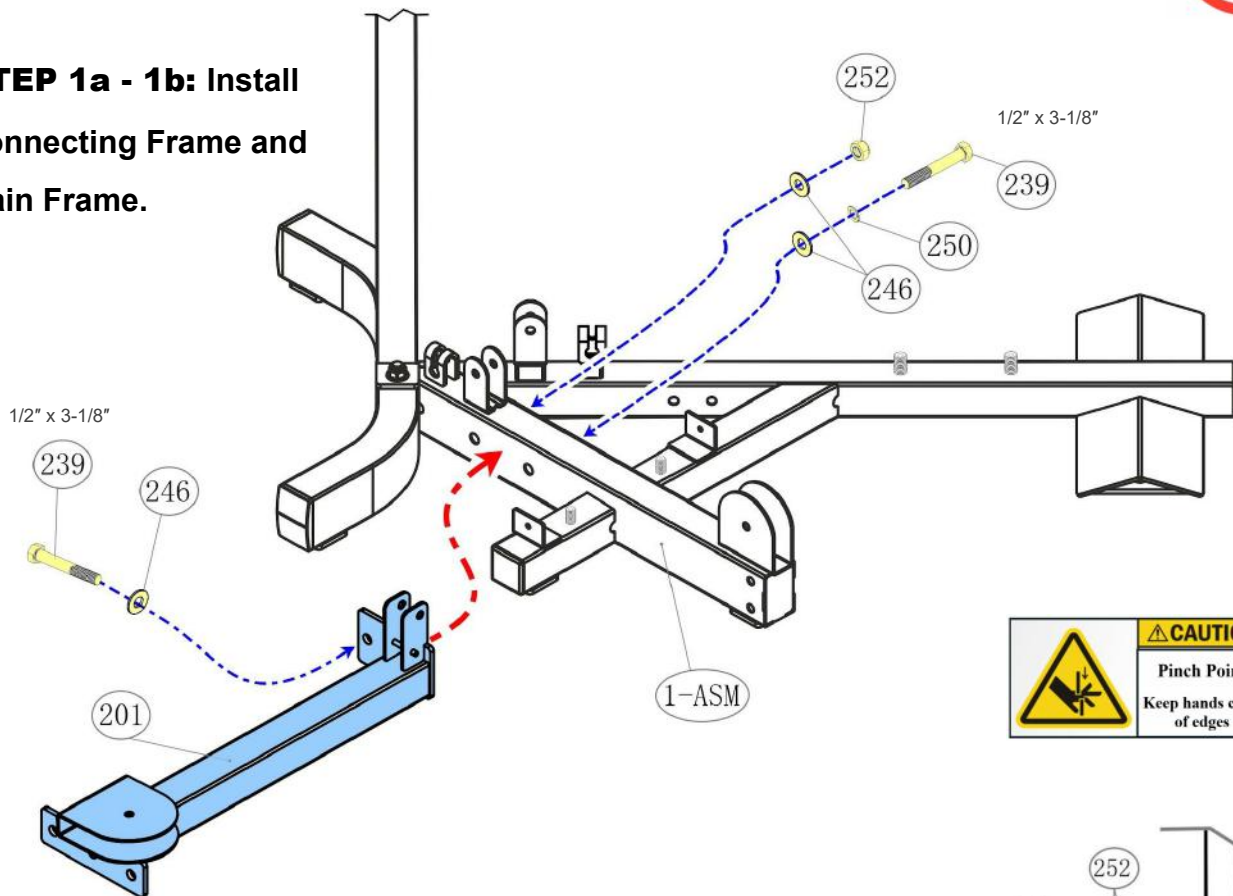

Part #	Assembly Parts List	QTY
GT-X-LP-201	Frame, Connecting to GT-X base unit	1
GT-X-LP-202-ASM	Frame, Main Base - Assembly	1

Part #	Assembly Hardware	QTY
GT-X-LP-239	Bolt, Hex Head, 1/2" x 3-1/8" L - BLK	2
GT-X-LP-240	Bolt, Hex Head, 1/2" x 4-1/8" L - BLK	2
GT-X-LP-246	Washer, Flat, 1/2" - BLK	7
GT-X-LP-250	Washer, Spring, 1/2" - BLK	1
GT-X-LP-252	Nut, Nylon Lock, 1/2" - BLK	3

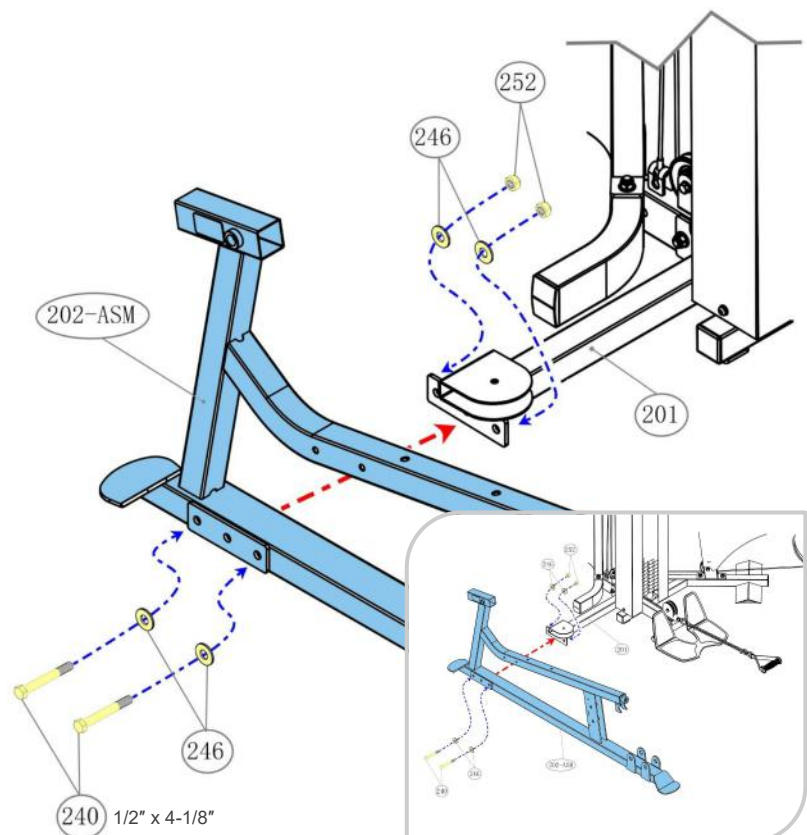

View Keys

Red dashed lines (large): Structural parts assembled direction.

Red dashed lines (med): Sub-parts assembled direction.

Blue dashed lines (small): Hardware assembled direction.

Orange (med): Cables are normally black, but easier to see in color.

Product Assembly, GT-LP (Leg Press), STEP 2a - 2b



Please Hand Tighten All Nuts & Bolts Until STEP 2f

STEP 2a - 2b: Install Front & Rear Leg Supports

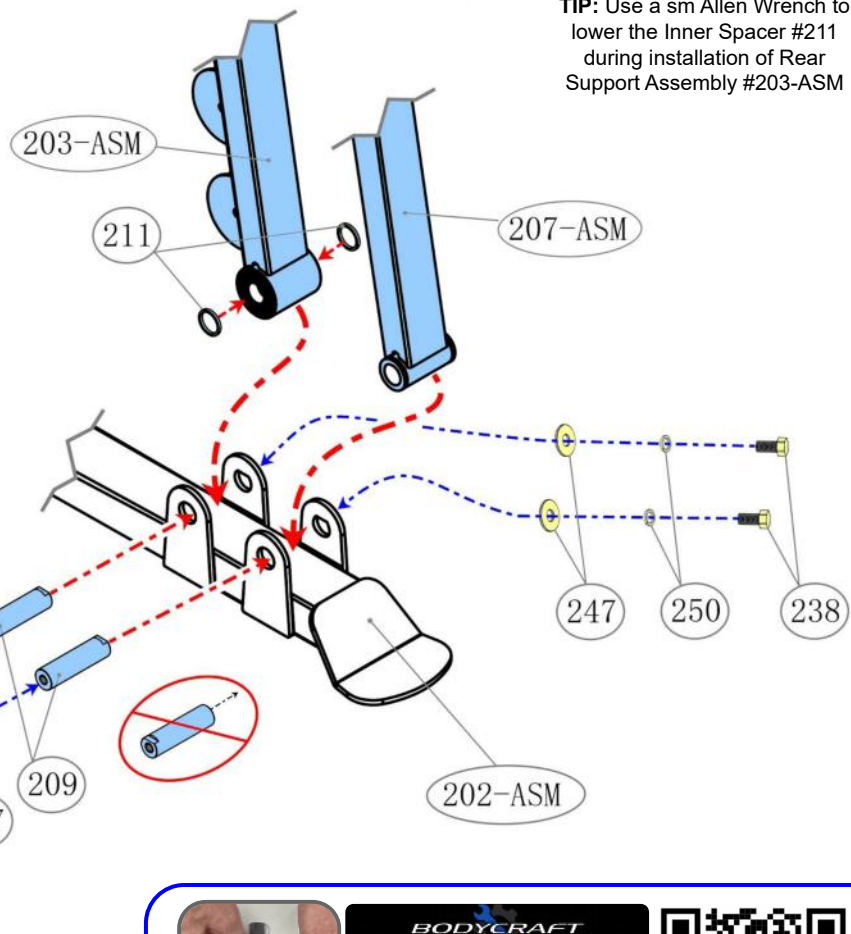
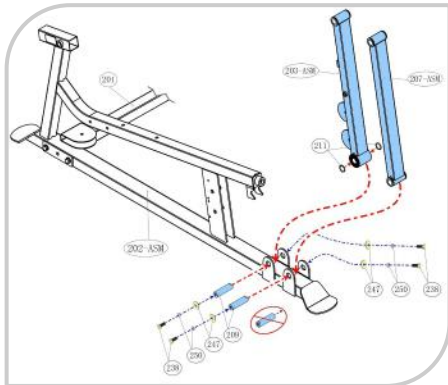

TIP: Use a sm Allen Wrench to lower the Inner Spacer #211 during installation of Rear Support Assembly #203-ASM



Flat notch through the right side to left side.



BODYCRAFT

[Watch Assembly Video](#)

GT-LP (Leg Press)
STEP 2b



Part #	Assembly Parts List	QTY
GT-X-LP-203-ASM	Leg Press Support, Rear - Assembly	1
GT-X-LP-207-ASM	Leg Press Support, Front - Assembly	1
GT-X-LP-209	Axle, w/ one side flat notch , 25mm OD x 1/2" ID threaded x 90mm L	2
GT-X-LP-211	Spacer, for Inner Side of Bottom Axle in the Rear Leg Support Frame	2

Part #	Assembly Hardware	QTY
GT-X-LP-238	Bolt, Hex Head, 1/2" x 1" L - BLK	4
GT-X-LP-247	Washer, Flat, Large, φ12 - BLK	4
GT-X-LP-250	Washer, Spring, 1/2" - BLK	4



STEP 2c: Install Hook to Rear Support.

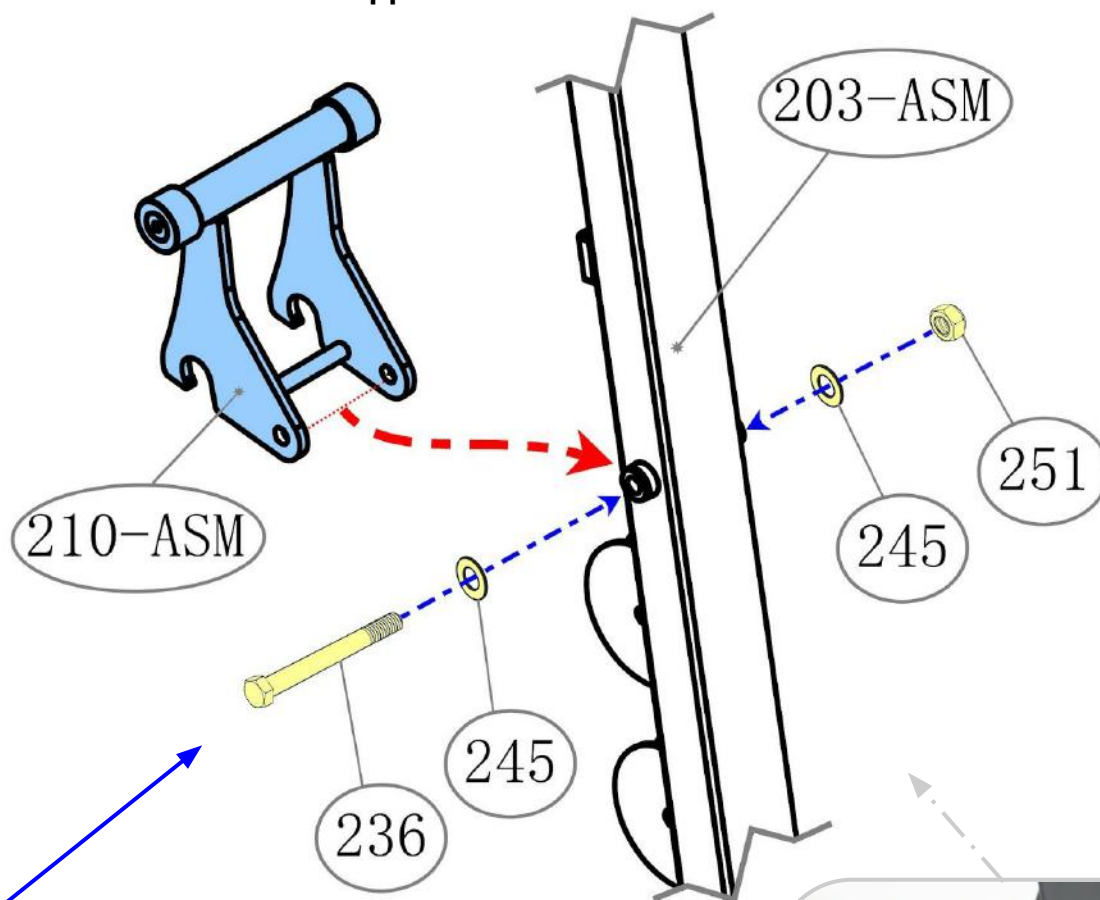

Note: Fully tighten until the gap is closed. Then loosen, up to 1/8 so that the Hook (210-ASM) will move but has no play. Loosen or tighten so Hook (210-ASM) will stay in the up position when not used.



Part #	Assembly Parts List	QTY
GT-X-LP-210-ASM	Hook, for Turbo Feature - Assembly	1

Part #	Assembly Hardware	QTY
GT-X-LP-236	Bolt, Hex Head, 3/8" x 4-1/4" L - BLK	1
GT-X-LP-245	Washer, Flat, 3/8" - BLK	2
GT-X-LP-251	Nut, Nylon Lock, 3/8" - BLK	1

Recommended Tools



Product Assembly, GT-LP (Leg Press), STEP 2d



Please Hand Tighten All Nuts & Bolts Until STEP 2f

STEP 2d: Install Leg Press Upper Connector

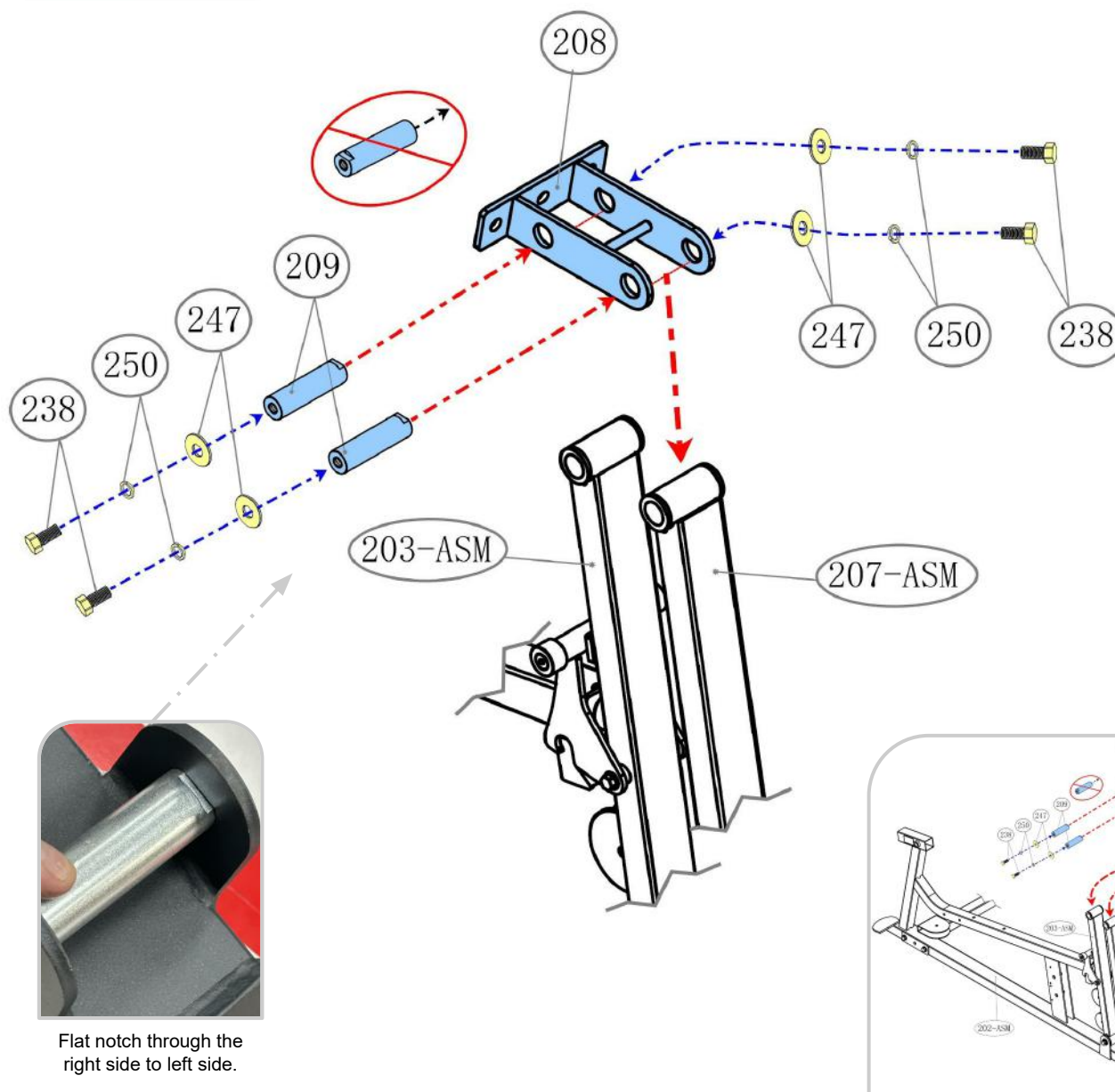

Flat notch through the right side to left side.

Part #	Assembly Parts List	QTY
GT-X-LP-208	Leg Press Upper Connector	1
GT-X-LP-209	Axle, w/ one side flat notch , 25mm OD x 1/2" ID threaded x 90mm L	2

Part #	Assembly Hardware	QTY
GT-X-LP-238	Bolt, Hex Head, 1/2" x 1" L - BLK	4
GT-X-LP-247	Washer, Flat, Large, $\phi 12$ - BLK	4
GT-X-LP-250	Washer, Spring, 1/2" - BLK	4

Product Assembly, GT-LP (Leg Press), STEP 2e - 2f "Torque Time"

STEP 2e: Install Foot Plate

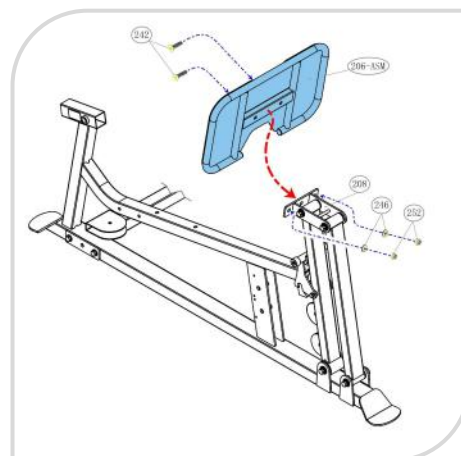
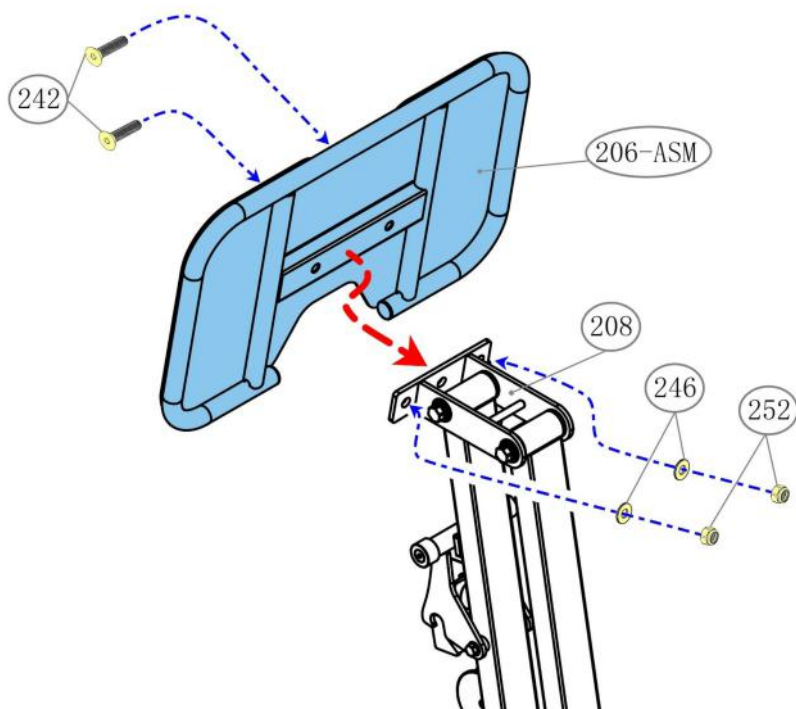

Part #	Assembly Parts List	QTY
GT-X-LP-206-ASM	Foot Plate, with Black Diamond Plate - Assembly	1

Part #	Assembly Hardware	QTY
GT-X-LP-242	Bolt, Recessed Countersunk Head, 1/2" x 2" L - BLK	2
GT-X-LP-246	Washer, Flat, 1/2" - BLK	2
GT-X-LP-252	Nut, Nylon Lock, 1/2" - BLK	2



STEP 2f: "Torque Time"

- Tighten all 1/2" Bolts & Nuts starting to the recommended torque specs of 20 ft-lbs (+/- 2 lbs)

Recommended Tools:



TORQUE WRENCH
w/ 3/4 SOCKET,
3/4 WRENCH, &
5/16 ALLEN HEX SOCKET

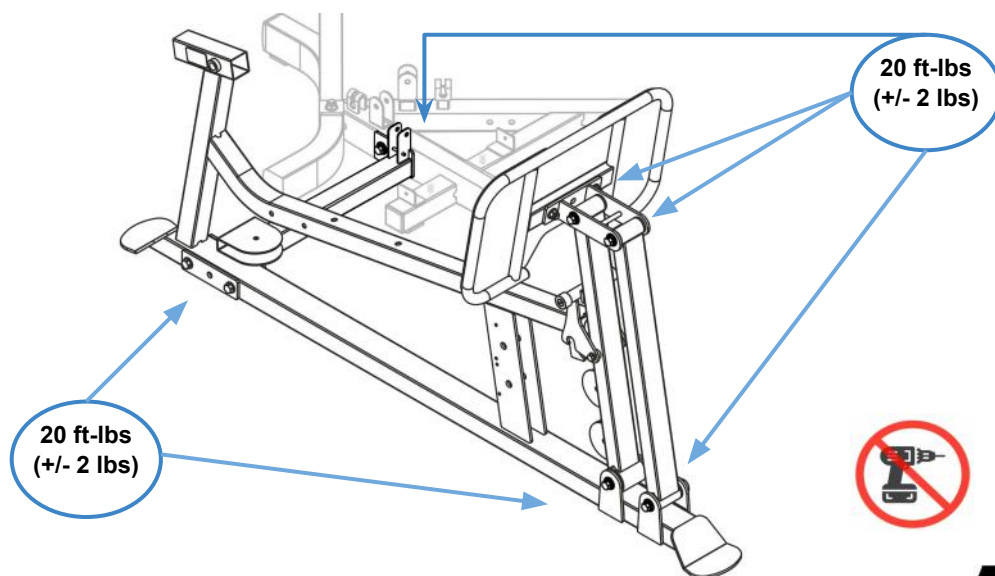



Please Hand Tighten All Nuts & Bolts Until STEP 3c

STEP 3a: Install Seat Handle Frame



Lightly tighten the bottom bolt #232 first

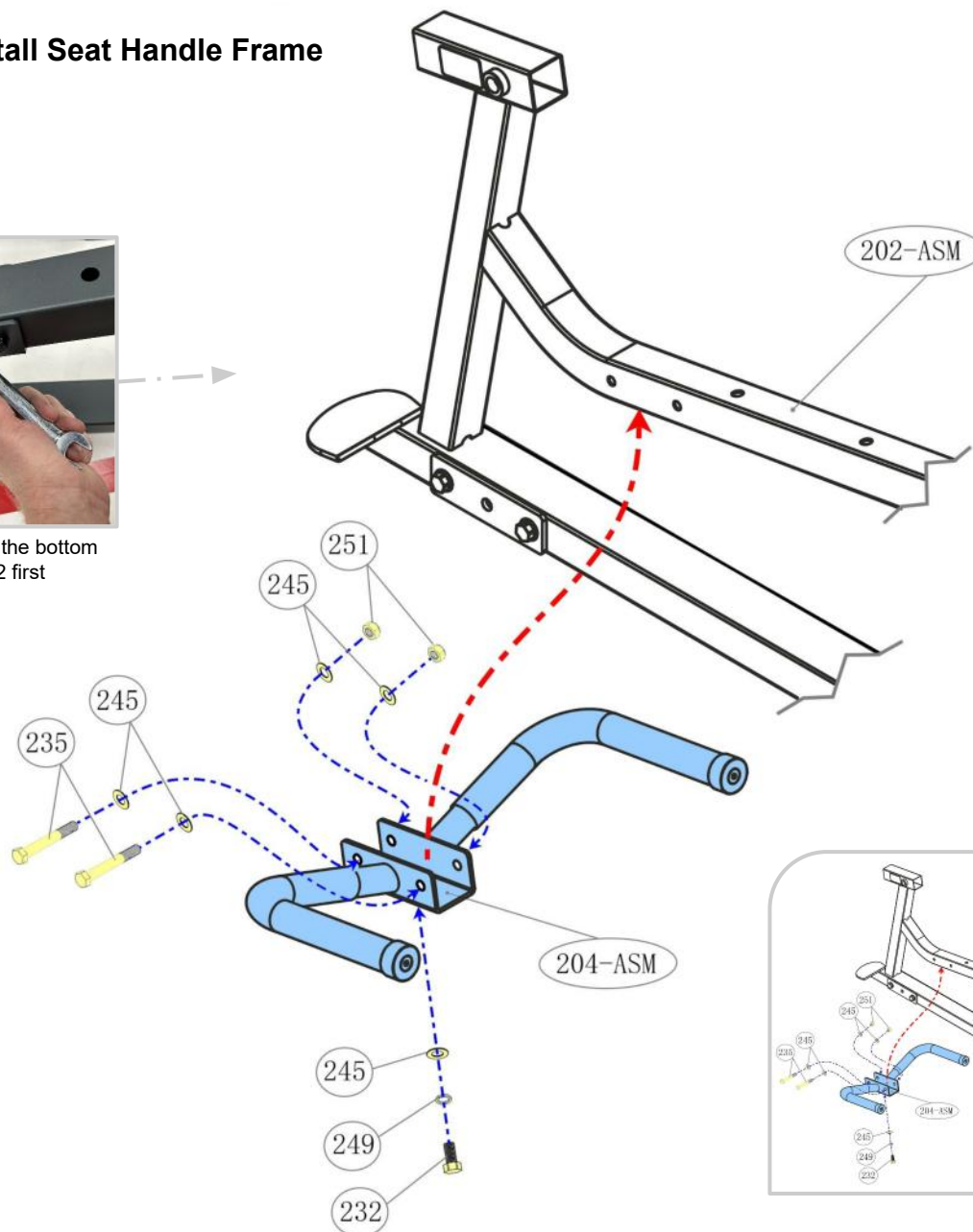

Part #	Assembly Parts List	QTY
GT-X-LP-204-ASM	Frame, Seat Handle - Assembly	1

Part #	Assembly Hardware	QTY
GT-X-LP-232	Bolt, Hex Head, 3/8" x 1" L - BLK	1
GT-X-LP-235	Bolt, Hex Head, 3/8" x 2-7/8" L - BLK	2
GT-X-LP-245	Washer, Flat, 3/8" - BLK	5
GT-X-LP-249	Washer, Spring, 3/8" - BLK	1
GT-X-LP-251	Nut, Nylon Lock, 3/8" - BLK	2



CAUTION
Pinch Point
Keep hands clear of edges

Product Assembly, GT-LP (Leg Press), STEP 3b - 3c "Torque Time"

STEP 3b: Install Back & Seat Pads

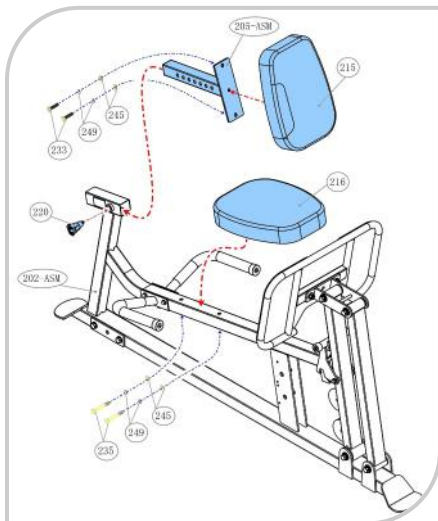

Use both back set of holes for Seat Pad #216

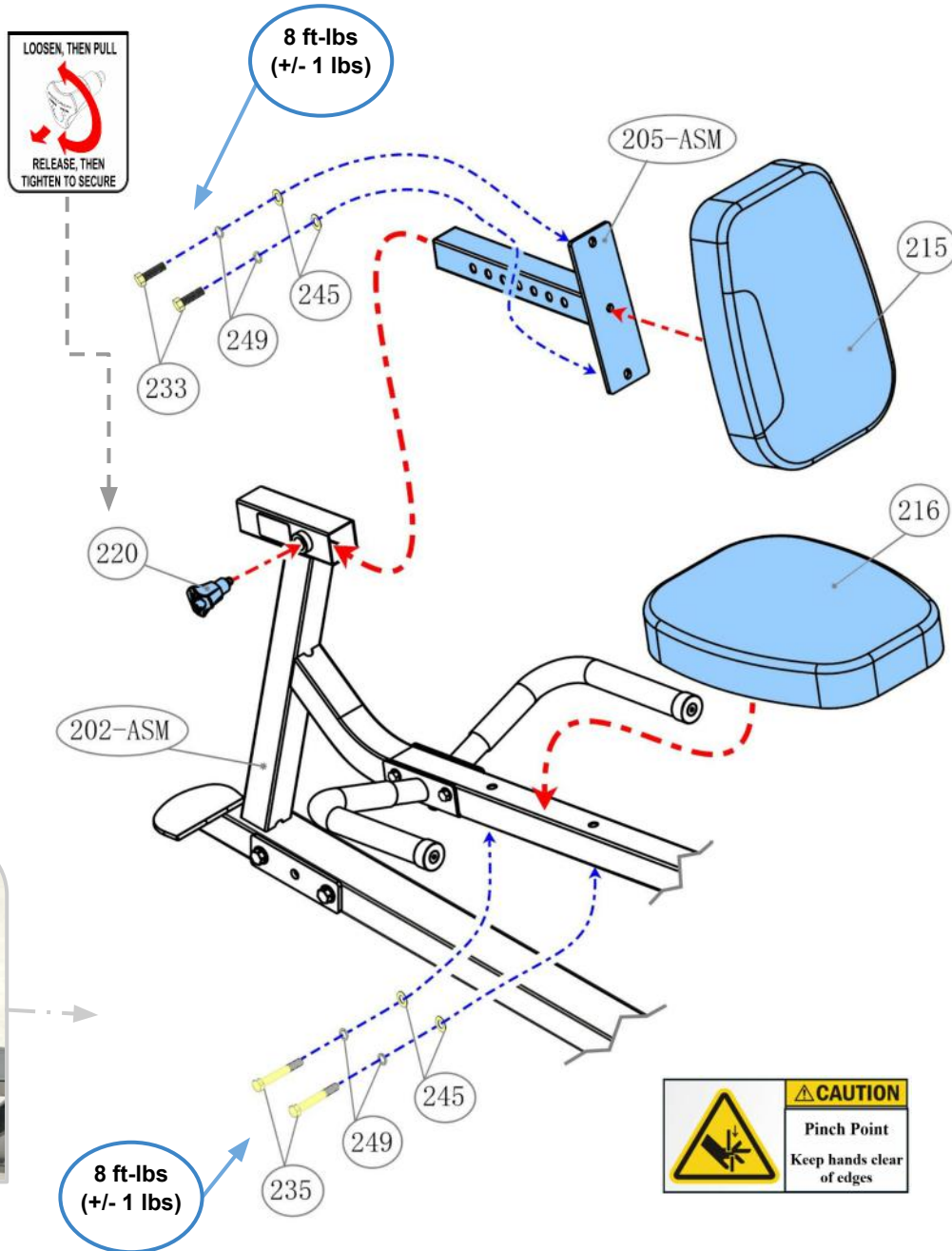

Part #	Assembly Parts List	QTY
GT-X-LP-205-ASM	Back Pad Adjuster - Assembly	1
GT-X-LP-215	Pad, Back for Leg Press	1
GT-X-LP-216	Pad, Seat for Leg Press	1
GT-X-LP-220	Pull-Pin Locking Knob, Aluminum - BLUE	1

Part #	Assembly Hardware	QTY
GT-X-LP-233	Bolt, Hex Head, 3/8" x 1-1/4" L - BLK	2
GT-X-LP-235	Bolt, Hex Head, 3/8" x 2-7/8" L - BLK	2
GT-X-LP-245	Washer, Flat, 3/8" - BLK	4
GT-X-LP-249	Washer, Spring, 3/8" - BLK	4

STEP 3c: "Torque Time"

- Tighten all 3/8" Bolts to the recommended torque specs of 8 ft-lbs (+/- 1 lbs)

Recommended Tools:



TORQUE WRENCH w/ 9/16 SOCKET & 9/16 WRENCH



Product Assembly, GT-LP (Leg Press), STEP 4 - OVERVIEW

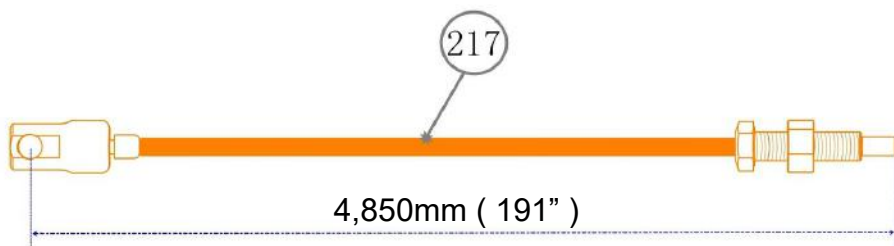

NOTE: Actual color of Leg Press Cable #217 is black. Shown in the assembly STEPS in **ORANGE** for easy viewing.

Part #	Assembly Parts List	QTY
GT-X-LP-217	Cable, Leg Press, 4,850mm (191")	1

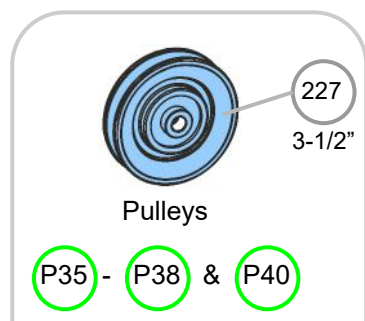

Pulleys are numbered w/ **GREEN** circles for installation routing.

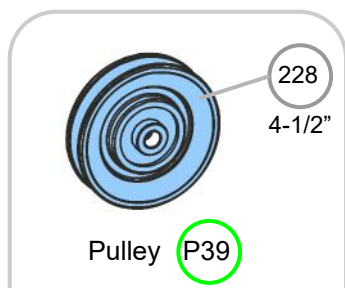

Pulleys are numbered w/ **GREEN** circles for installation routing.

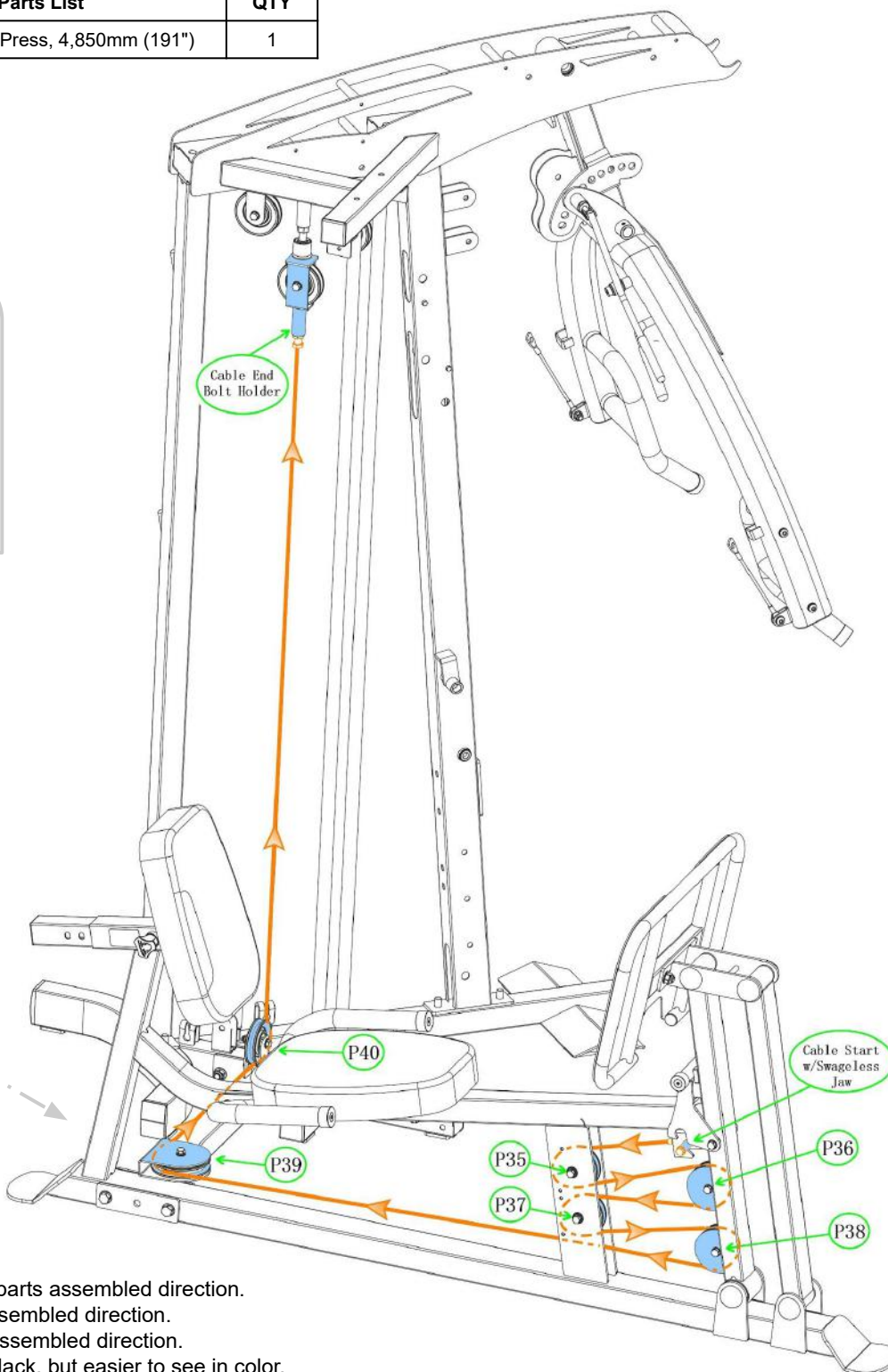

View Keys

Red dashed lines (large): Structural parts assembled direction.

Red dashed lines (med): Sub-parts assembled direction.

Blue dashed lines (small): Hardware assembled direction.

Orange (med): Cables are normally black, but easier to see in color.

Product Assembly, GT-LP (Leg Press), STEP 4a



Please Hand All Nuts & Bolts Until STEP 5

STEP 4a: Install Cable w/ Spacers

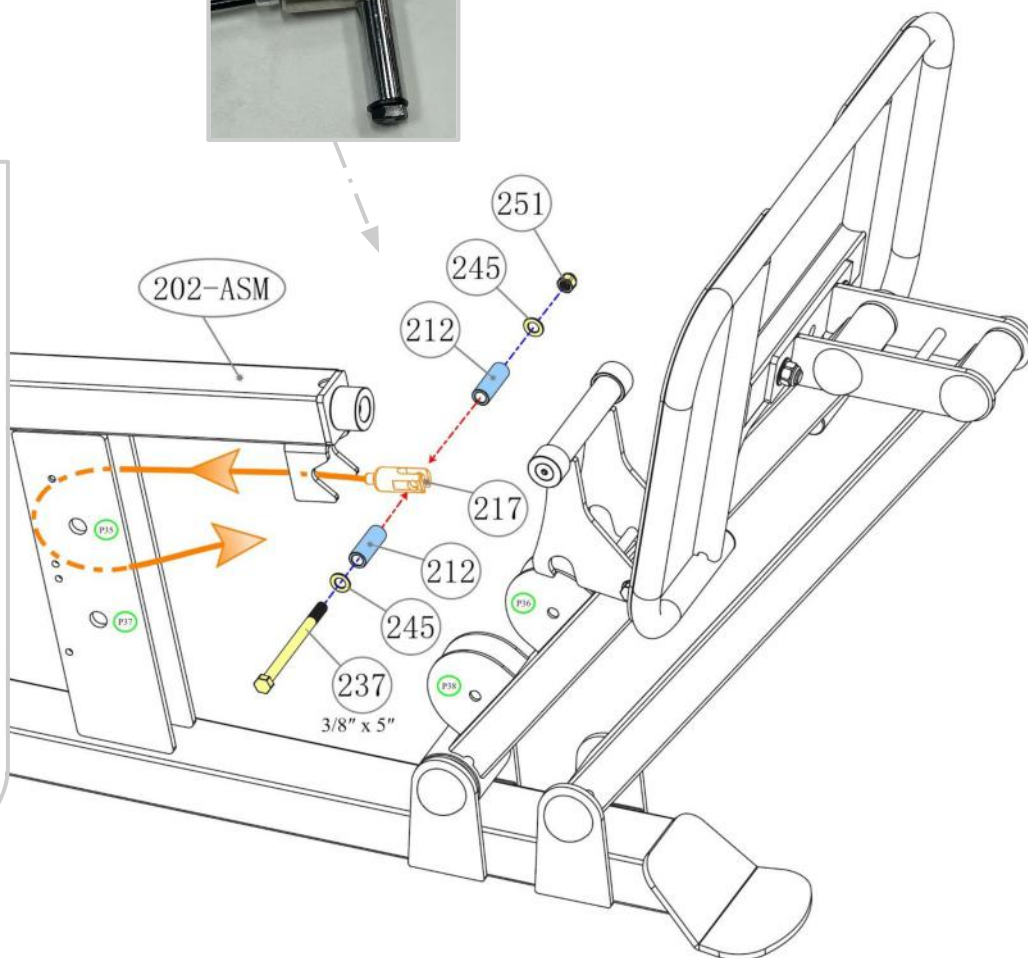
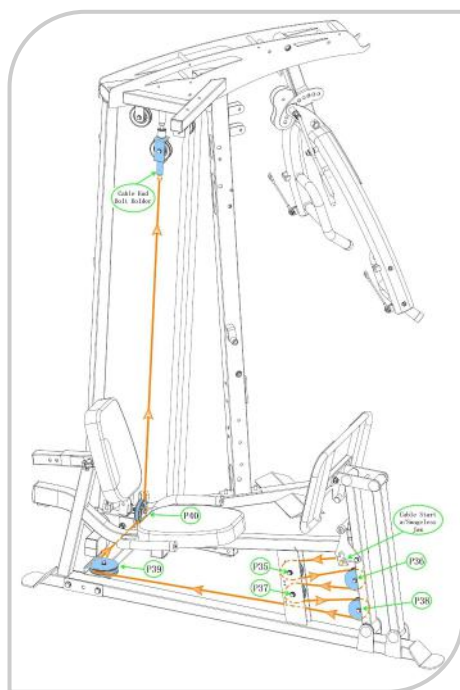

Part #	Assembly Parts List	QTY
GT-X-LP-212	Spacer, 10.5mm OD x 16mm ID x 46mm L - Chrome	2
GT-X-LP-217	Cable, Leg Press, 4,850mm (191")	1

Part #	Assembly Hardware	QTY
GT-X-LP-237	Bolt, Hex Head, 3/8" x 5" L - BLK	1
GT-X-LP-245	Washer, Flat, 3/8" - BLK	2
GT-X-LP-251	Nut, Nylon Lock, 3/8" - BLK	1

Product Assembly, GT-LP (Leg Press), STEP 4b - 4c



Please Hand Tighten All Nuts & Bolts Until STEP 5

STEP 4b - 4c: Install Pulleys P35 & P36 (3-1/2")

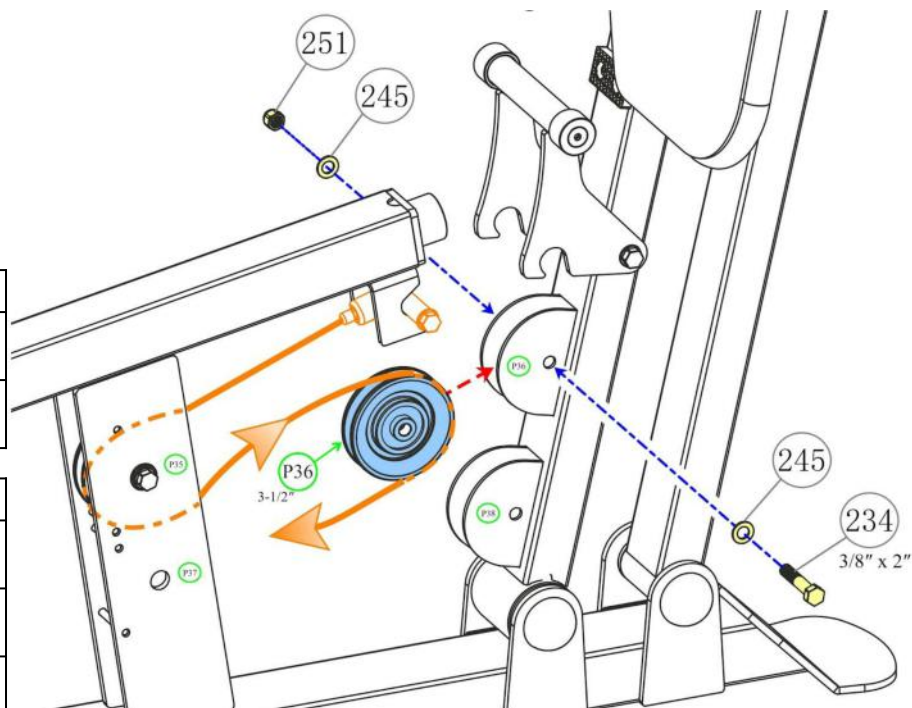
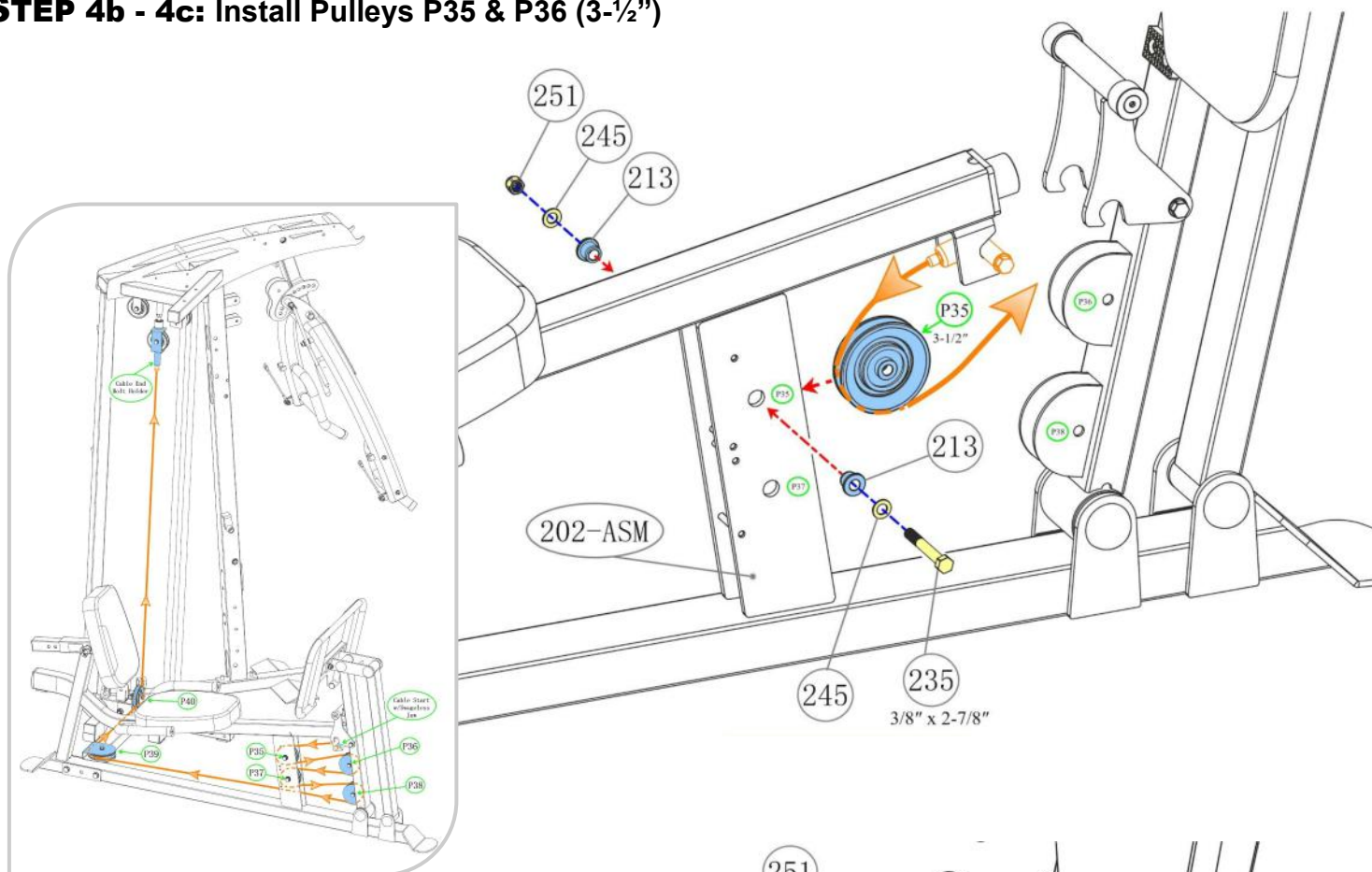

Part #	Assembly Parts List	QTY
GT-X-LP-213	Bushing, Plastic, for Pulley to Frame	2
GT-X-LP-227	Pulley, 90mm (3-1/2") x 526mm ID	2

Part #	Assembly Hardware	QTY
GT-X-LP-234	Bolt, Hex Head, 3/8" x 2" L - BLK	1
GT-X-LP-235	Bolt, Hex Head, 3/8" x 2-7/8" L - BLK	1
GT-X-LP-245	Washer, Flat, 3/8" - BLK	4
GT-X-LP-251	Nut, Nylon Lock, 3/8" - BLK	2



Please Hand Tighten All Nuts & Bolts Until STEP 5

STEP 4d - 4e: Install Pulleys P37 & P38 (3-1/2")

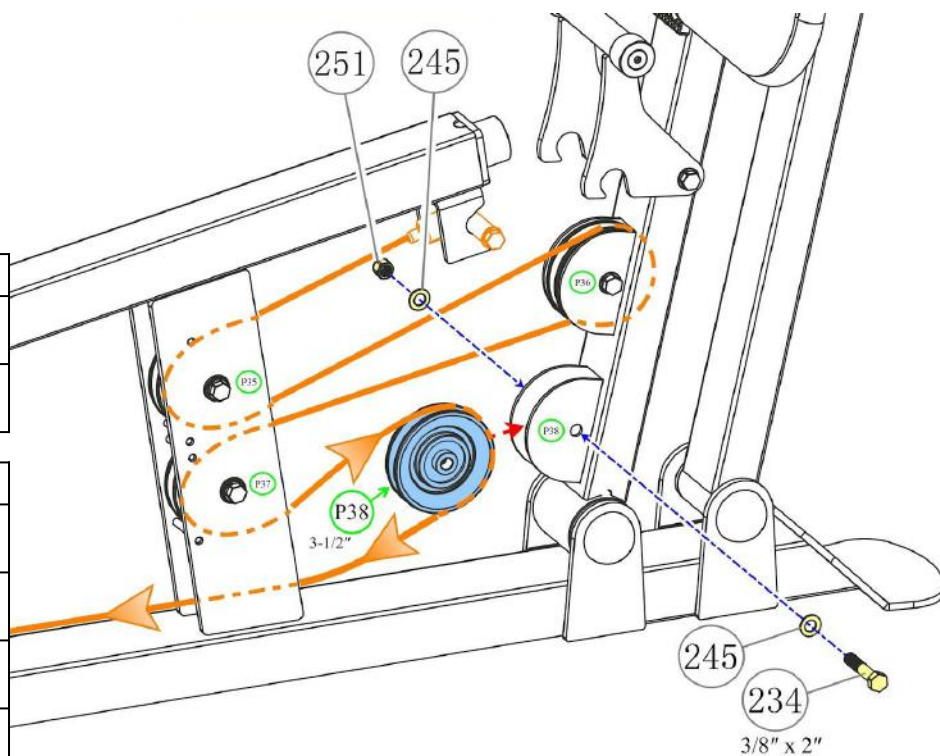
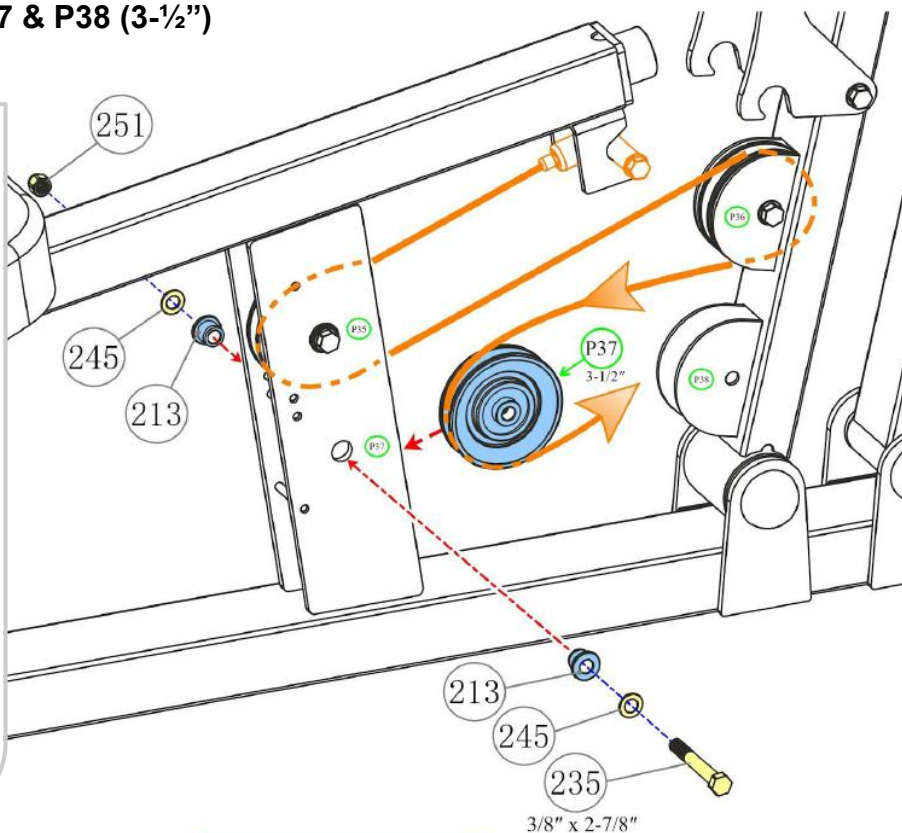
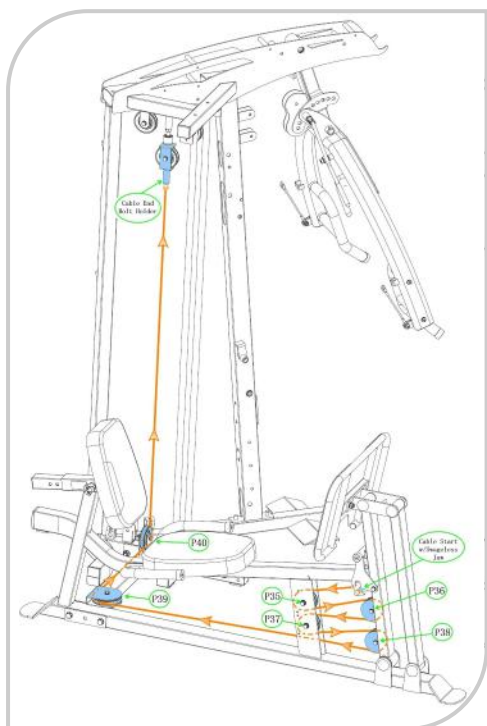

Part #	Assembly Parts List	QTY
GT-X-LP-213	Bushing, Plastic, for Pulley to Frame	2
GT-X-LP-227	Pulley, 90mm (3-1/2") x 526mm ID	2

Part #	Assembly Hardware	QTY
GT-X-LP-234	Bolt, Hex Head, 3/8" x 2" L - BLK	1
GT-X-LP-235	Bolt, Hex Head, 3/8" x 2-7/8" L - BLK	1
GT-X-LP-245	Washer, Flat, 3/8" - BLK	4
GT-X-LP-251	Nut, Nylon Lock, 3/8" - BLK	2



Please Hand Tighten All Nuts & Bolts Until STEP 5

STEP 4f - 4g: Install Pulleys P39 (4-1/2") & P40 (3-1/2")

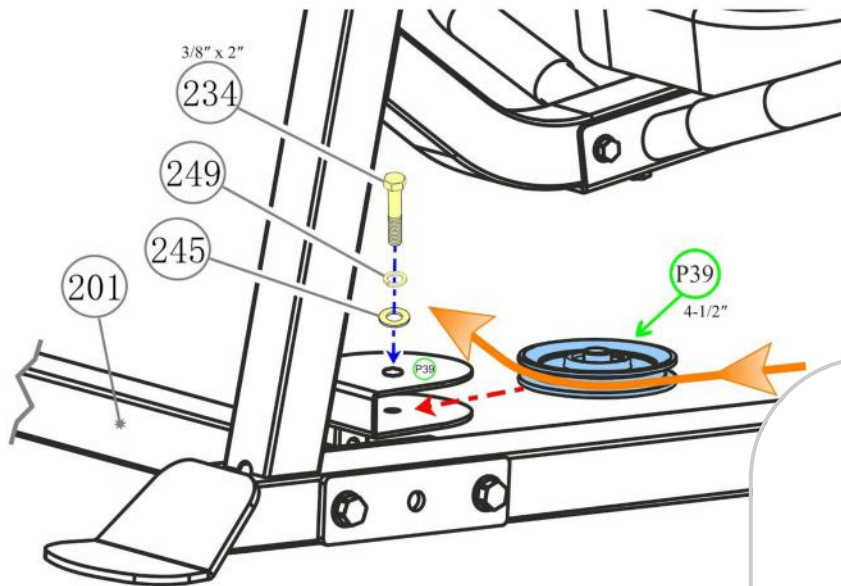

Part #	Assembly Parts List	QTY
GT-X-LP-227	Pulley, 90mm (3-1/2") x 526mm ID	1
GT-X-LP-228	Pulley, 114mm (4-1/2") x 526mm ID	1

Part #	Assembly Hardware	QTY
GT-X-LP-234	Bolt, Hex Head, 3/8" x 2" L - BLK	2
GT-X-LP-245	Washer, Flat, 3/8" - BLK	3
GT-X-LP-249	Washer, Spring, 3/8" - BLK	1
GT-X-LP-251	Nut, Nylon Lock, 3/8" - BLK	1

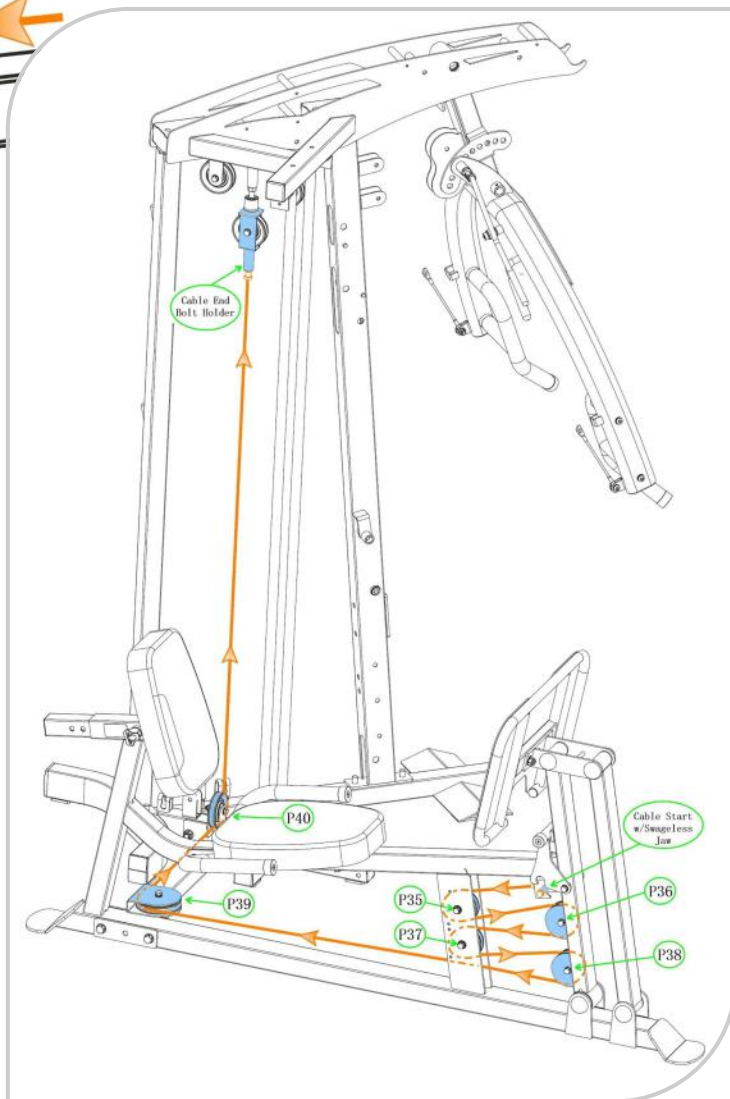
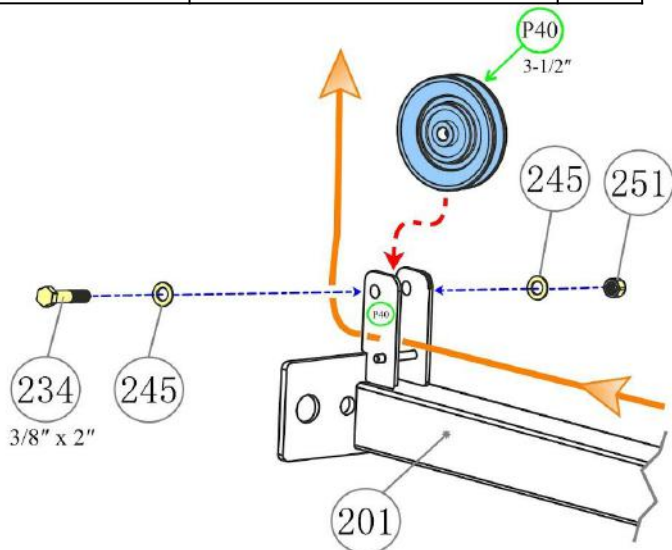

DECISION POINT

If you currently have a GT Strength Training System and are now adding the GT-LP Leg Press Option:

Go to STEP 4h below

If you are simultaneously assembling the:

- GT Strength Training System

AND

- GT-LP Leg Press Option

Go to STEP 4i

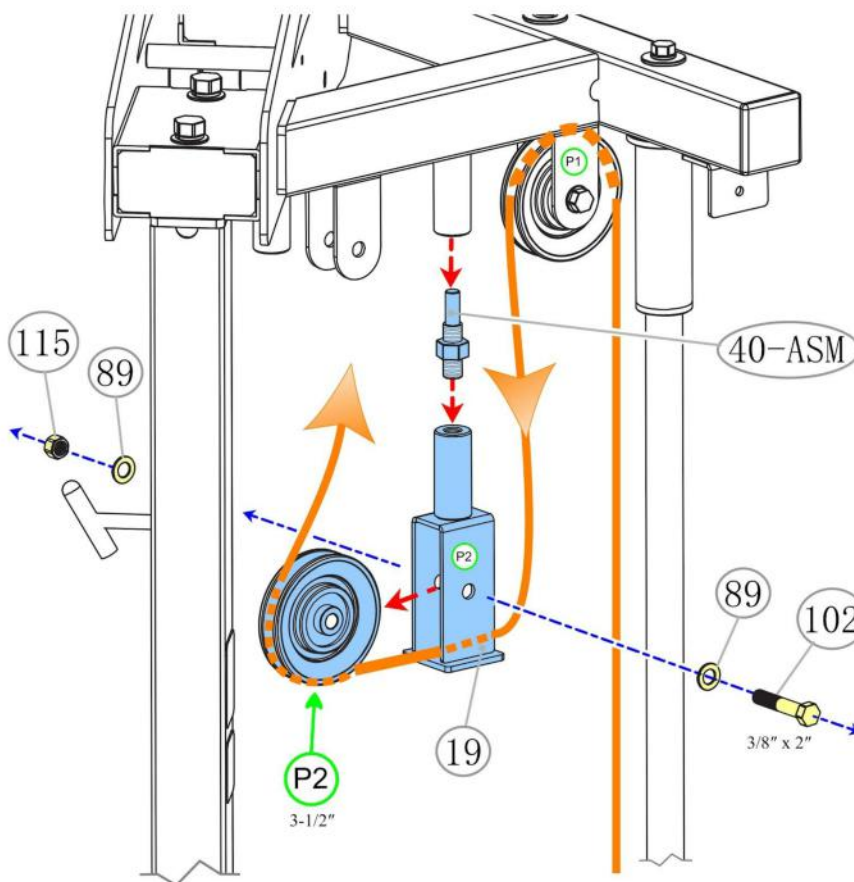

STEP 4h: Take off Threaded Rod #40-ASM and flip Pulley Block #19

Recommended Tools



Part #	Assembly Parts List	QTY
GT-X-019	Pulley Block, Single Closed Flat End, w/ Cable End Threaded Shaft	1
GT-X-040-ASM	Threaded Rod, between Top Connector Frame & Single Block Pulley (Not used w/ Leg Press) - Assembly	1

Part #	Assembly Hardware	QTY
GT-X-089	Washer, Flat, 3/8\" - BLK	2
GT-X-102	Bolt, Hex Head, 3/8\" x 2\" L - BLK	1
GT-X-115	Nut, Nylon Lock, 3/8\" - BLK	1



Please Hand Tighten All Nuts & Bolts Until STEP 5

STEP 4i: Install Adjustable Stopper and Leg Press Cable

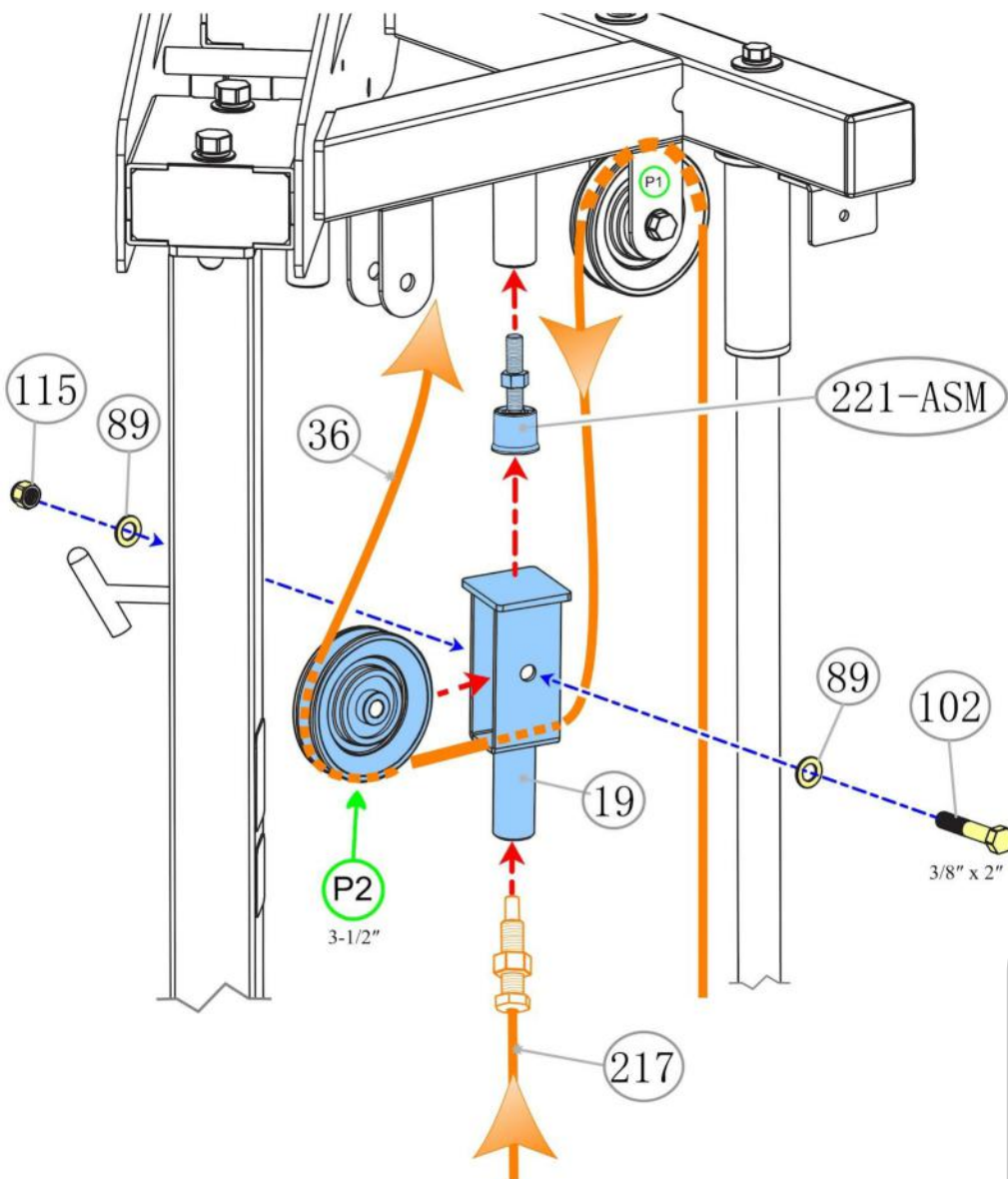

Recommended Tool



ADJUSTABLE WRENCH

Screw in Adjustable Stopper 50% into the Top Connector Frame.

Then screw in Cable (217) Bolt 50% into the Pulley Block.

Tighten both Jam Nuts at this time.

Part #	Assembly Parts List	QTY
GT-X-019	Pulley Block, Single Closed Flat End, w/ Cable End Threaded Shaft	1
GT-X-LP-217	Cable, Leg Press, 4,850mm (191")	1
GT-X-LP-221-ASM	Adjustable Stopper, between Top Connector Frame & Single Block Pulley - Assembly	1

Part #	Assembly Hardware	QTY
GT-X-089	Washer, Flat, 3/8" - BLK	2
GT-X-102	Bolt, Hex Head, 3/8" x 2" L - BLK	1
GT-X-115	Nut, Nylon Lock, 3/8" - BLK	1

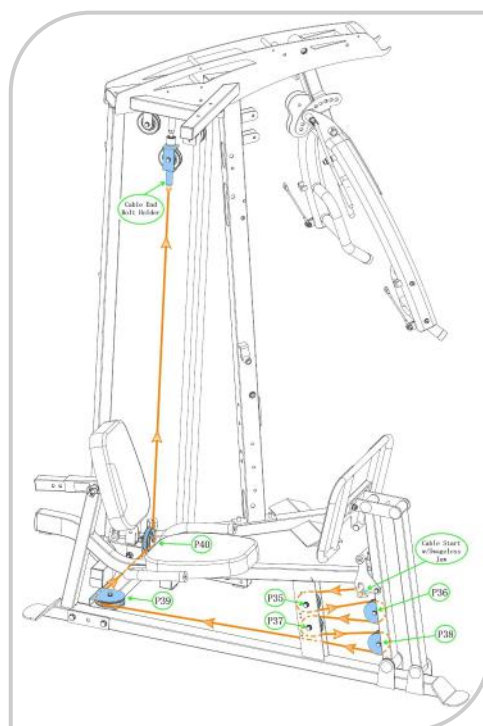

Product Assembly, GT-LP (Leg Press), STEP 5 “Torque Time”

STEP 5: “Torque Time”

- Tighten the 3/8” Bolts from STEP 4a - STEP 4i to the recommended torque specs of **17 ft-lbs (+/- 2 lbs)**

NOTE: The 3/8” Bolts with Plastic Bushings to the torque specs of **8 ft-lbs (+/- 1 lbs)**



Recommended Tools:



TORQUE WRENCH w/ 9/16 SOCKET
& 9/16 WRENCH

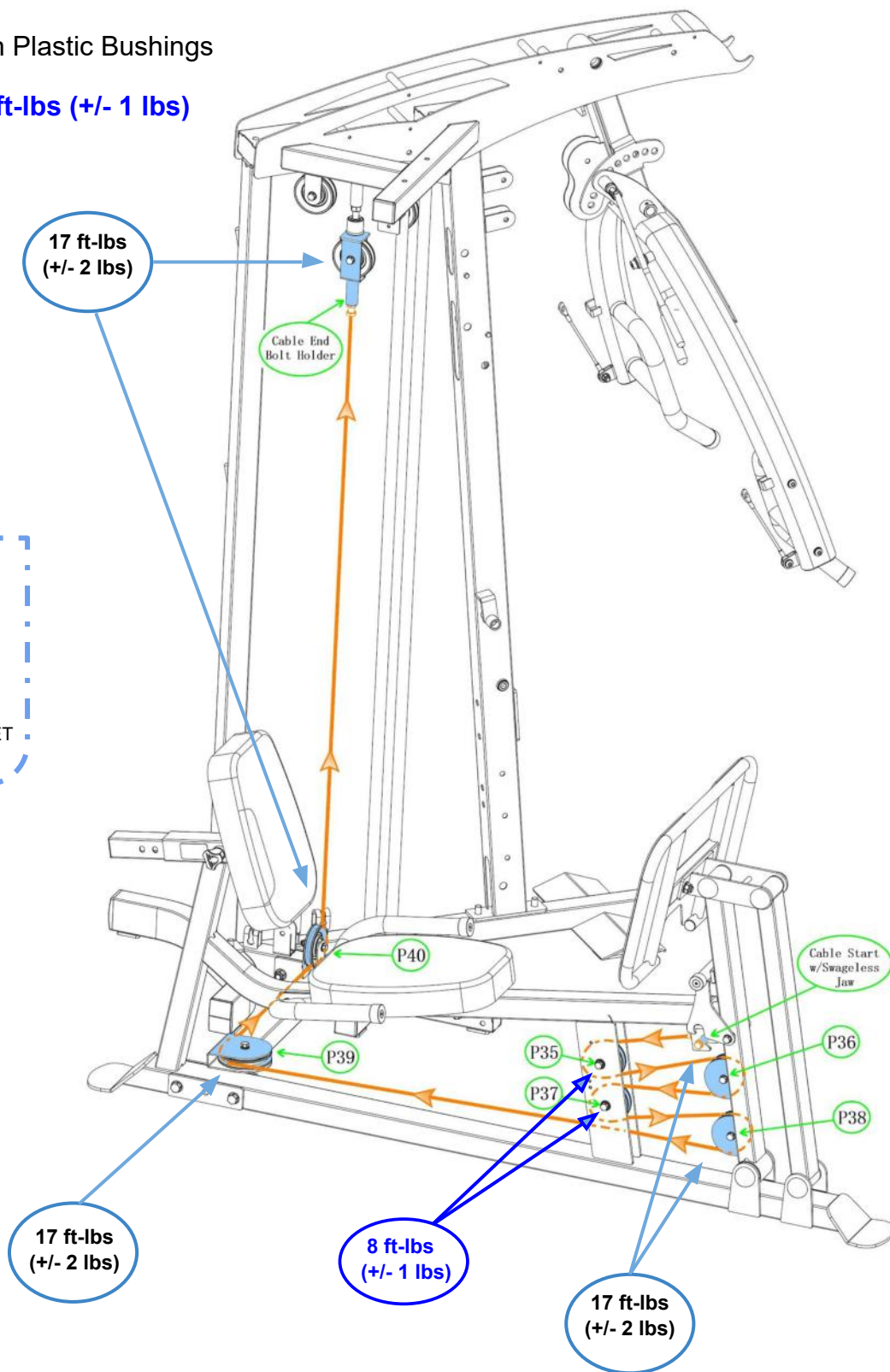

Product Assembly, GT-LP (Leg Press), STEP 6a - 6b

STEP 6a: Install Plastic Domed Caps (Total of 8, on both right & left sides)

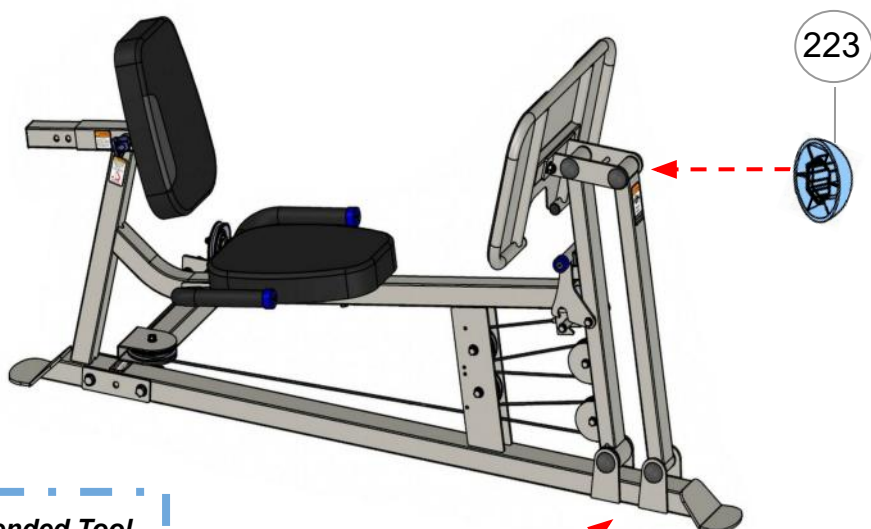

Recommended Tool



RUBBER MALLET

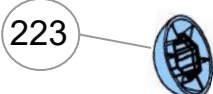

Part #	Assembly Parts List	QTY
GT-X-LP-223	Cap, Plastic, Domed for 1/2" Bolt & Nut Ends	8

STEP 6b: Adjust the Cable for Correct Tension.

- End of Cable #217 then secure the lock nut.
- Adjustable Stopper #221-ASM then secure the lock nut.

Recommended Tools



ADJUSTABLE WRENCHES

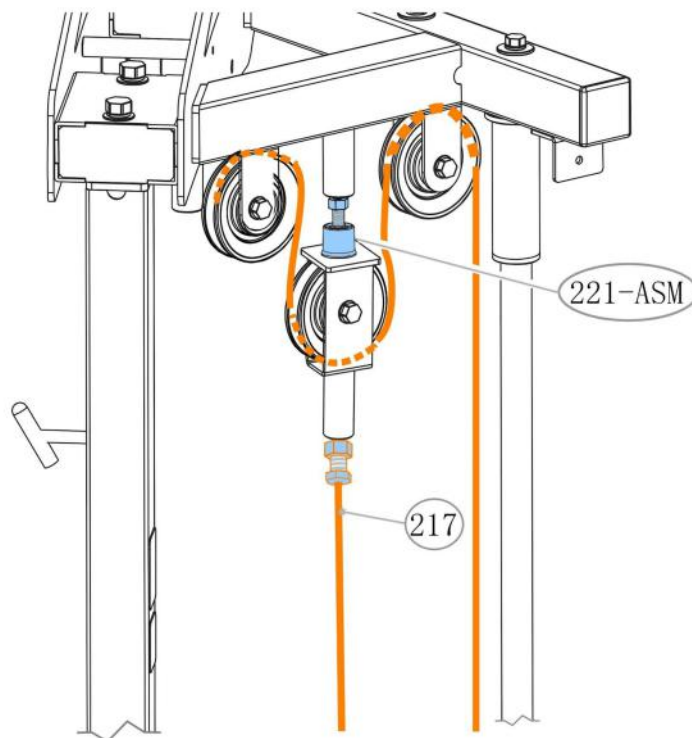

BODYCRAFT

[Watch Assembly Video](#)

GT-LP (Leg Press)
STEP 6b - Adj. Cables

Part #	Assembly Parts List	QTY
GT-X-LP-217	Cable, Leg Press, 4,850mm (191")	1
GT-X-LP-221-ASM	Adjustable Stopper, between Top Connector Frame & Single Block Pulley - Assembly	1

STEP 7: Final Assembly Clean Up & Polish



STEP 7a: Remove all Assembly Stickers, i.e. Part Numbers & Right / Left Circles

- Easy to remove with fingernail or plastic scraper
- If adhesive residue is on frame:
 - Use rubbing alcohol
 - Then mild cleaning solution
 - Finishing with a dry 100% cotton cleaning cloth



STEP 7b: Frame Clean Up

- Wipe down frame with mild cleaning solution
- Dry frame with 100% cotton cleaning cloth
- Good practice to do before first use and yearly:
 - Lightly apply an automotive grade cleaner wax
 - Then follow up by wiping excesses off with 100% cotton cleaning cloth



MILD CLEANING SOLUTION



100% COTTON CLEANING CLOTHS

- DO NOT USE ABRASIVE CLEANING SCRUBBING PADS
- DO NOT USE AMMONIA OR CITRIC CLEANERS
- DO NOT USE ANY FORM OF PAINT THINNERS

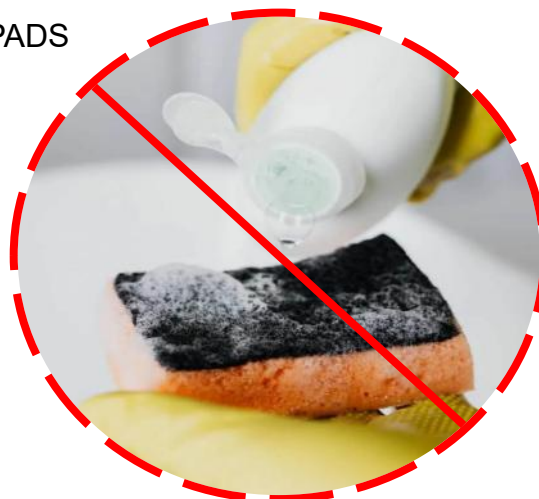

TIP ON FRAME ONLY: For extra protection from fingerprints, sweat stains or just plain dirt, apply an automotive grade cleaner wax if desired. Also makes future cleaning easier.



(Do Not Use on the Upholstery)

Detailed Parts List, GT-LP (Leg Press)

1 of 2

Part #	Detailed Parts list	QTY
GT-X-LP-201	Frame, Connecting to GT-X base unit	1
GT-X-LP-202	Frame, Main Base	1
GT-X-LP-203	Leg Press Support, Rear	1
GT-X-LP-204	Frame, Seat Handle	1
GT-X-LP-205	Back Pad Adjuster	1
GT-X-LP-206	Foot Plate, with Black Diamond Plate	1
GT-X-LP-207	Leg Press Support, Front	1
GT-X-LP-208	Leg Press Upper Connector	1
GT-X-LP-209	Axle, w/ one side flat notch , 25mm OD x 1/2" ID threaded x 90mm L	4
GT-X-LP-210	Hook, for Turbo Feature	1
GT-X-LP-211	Spacer, for Inner Side of Bottom Axle in the Rear Leg Support Frame	2
GT-X-LP-212	Spacer, End of Cable #217 for Hook, 10.5mm OD x 16mm ID x 46mm L - Chrome	2
GT-X-LP-213	Bushing, Plastic, for Pulley to Frame, 3/8" ID	4
GT-X-LP-214	Handrail Rubber Grip	2
GT-X-LP-215	Pad, Back for Leg Press	1
GT-X-LP-216	Pad, Seat for Leg Press	1
GT-X-LP-217	Cable, Leg Press, 4,870mm (191.73") L	1
GT-X-LP-218	End Cap, Large, Aluminum, Blue, 1	2
GT-X-LP-219	End Cap, Small, Aluminum, Blue, 2	2
GT-X-LP-220	Pull-Pin Locking Knob, Aluminum - BLUE	1
GT-X-LP-221	Adjustable Stopper, between Top Connector Frame & Single Block Pulley	1
GT-X-LP-222	Cushion (rectangle), for Hook	1
GT-X-LP-223	Cap, Plastic, Domed for 1/2" Bolt & Nut Ends	8
GT-X-LP-224	Stopper, for Leg Press to Main Frame	1
GT-X-LP-225	Plug, Round, ϕ 25mm	2
GT-X-LP-226	Plug, Square, 45mm x 45mm	1
GT-X-LP-227	Pulley, 90mm (3-1/2") x ϕ 26mm ID	5
GT-X-LP-228	Pulley, 114mm (4-1/2") x ϕ 26mm ID	1
GT-X-LP-229	Bushing, Flange, Iglide Sleeve Bearing, MFM-2532-20	6
GT-X-LP-230	Bushing, Flange, Iglide Sleeve Bearing, MFM-1014-10	2
GT-X-LP-231	Bearing, w/ Deep Groove Ball, 6205-2Z (C0)	2

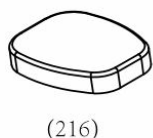
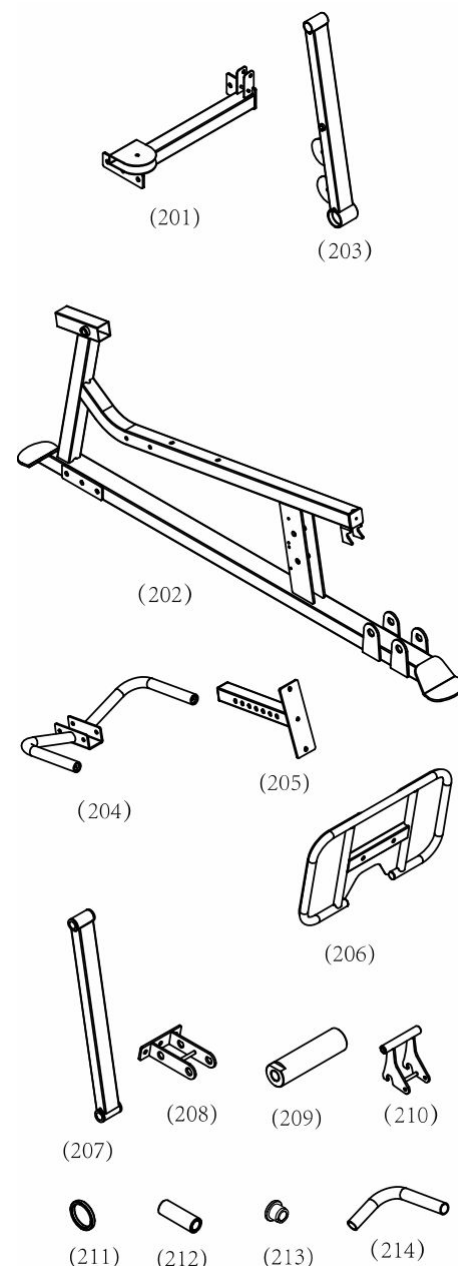

NOTE: Parts are not to scale

Part #	Detailed Parts list	QTY
GT-X-LP-232	Bolt, Hex Head, 3/8" x 1" L - BLK	1
GT-X-LP-233	Bolt, Hex Head, 3/8" x 1-1/4" L - BLK	2
GT-X-LP-234	Bolt, Hex Head, 3/8" x 2" L - BLK	4
GT-X-LP-235	Bolt, Hex Head, 3/8" x 2-7/8" L - BLK	6
GT-X-LP-236	Bolt, Hex Head, 3/8" x 4-1/4" L - BLK	1
GT-X-LP-237	Bolt, Hex Head, 3/8" x 5" L - BLK	1
GT-X-LP-238	Bolt, Hex Head, 1/2" x 1" L - BLK	8
GT-X-LP-239	Bolt, Hex Head, 1/2" x 3-1/8" L - BLK	2
GT-X-LP-240	Bolt, Hex Head, 1/2" x 4-1/8" L - BLK	2
GT-X-LP-241	Bolt, Recessed Countersunk Head, 5/16" x 1" L - BLK	4
GT-X-LP-242	Bolt, Recessed Countersunk Head, 1/2" x 2" L - BLK	2
GT-X-LP-243	Bolt, Recessed Flat Head, 5/16" x 1" L - BLK	1
GT-X-LP-244	Screw, Pan Head Phillips Drive, M4 x 10mm L - BLK	2
GT-X-LP-245	Washer, Flat, 3/8" - BLK	24
GT-X-LP-246	Washer, Flat, 1/2" - BLK	9
GT-X-LP-247	Washer, Flat, Large, φ12 - BLK	8
GT-X-LP-248	Washer, Flat, Large, φ4 - BLK	2
GT-X-LP-249	Washer, Spring, 3/8" - BLK	6
GT-X-LP-250	Washer, Spring, 1/2" - BLK	9
GT-X-LP-251	Nut, Nylon Lock, 3/8" - BLK	9
GT-X-LP-252	Nut, Nylon Lock, 1/2" - BLK	5
GT-X-LP-253	Nut, 1/2" - BLK	1
GT-X-LP-254	Washer, Flat, 5/16" - BLK	1
GT-X-LP-255	Warning Label - Pull-Pin Locking Knob - v1.6	1
GT-X-LP-256	Warning Label - Pinch Point, Vertical - v1.6	1
GT-X-LP-257	Label - Serial Number w/ US Patent No.	1
GT-X-LP-258	Warning label - Be Aware of Moving Parts - v1.6	1
GT-X-LP-259	Wrench, Hex, 5/16"	1
GT-X-LP-260	Poster - Exercise Guide	1

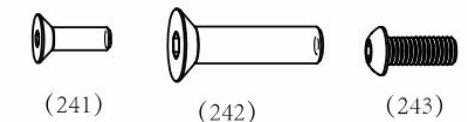
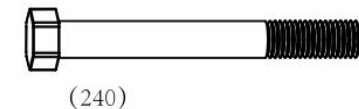
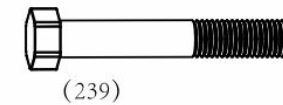
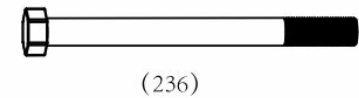

NOTE: Parts are not to scale

Detailed Parts, Exploded View, GT-LP (Leg Press)

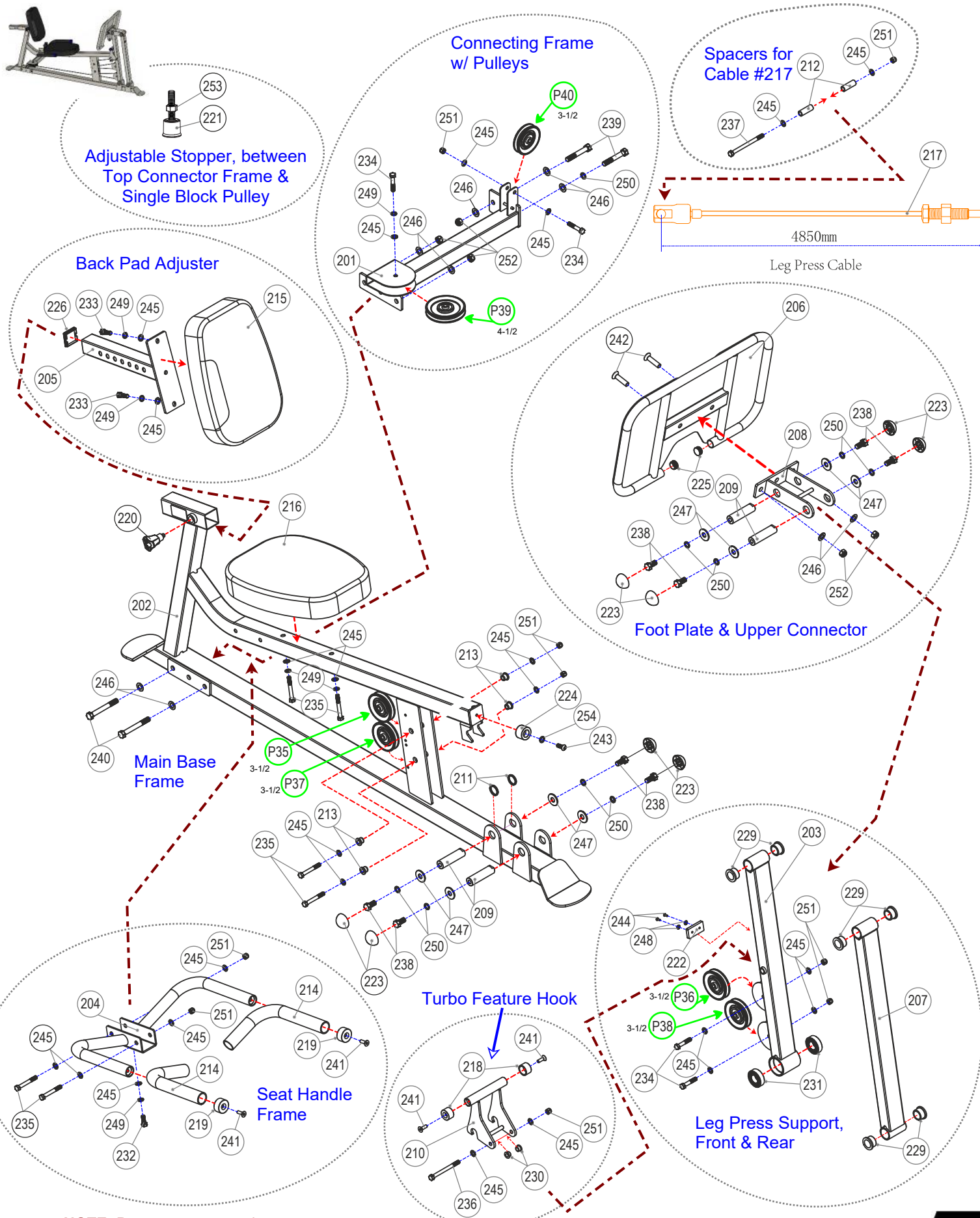

Required Information BEFORE Initiating a Service Case

The following information is needed to help expedite troubleshooting and to ensure the correct part(s) are sent if needed for a repair:

- 1) What product / model # do you have?
- 2) Unit serial number?
- 3) Installed by a dealer or direct sale?
- 4) Date of installation?
- 5) Date of service issue?
- 6) Complaint or problem, including any Error Codes?
- 7) Has the software been updated?
- 8) What part(s) are being requested?
- 9) Any picture or video will help with troubleshooting or exact part(s) needed.

Product Warranty - Strength (Home Use)

VALID FOR USA AND CANADA ONLY

(Please consult with your local distributor for warranty info specific to your region).

BODYCRAFT warrants its products to be free of defects in materials and workmanship for the time stated below to the original purchaser.

Register your product within 30 days of purchase at www.bodycraft.com or call 800-990-5556

This warranty is valid only in accordance with the following conditions:

The warranty begins on the original purchase date at retail and ends when the original owner disposes of it, either through sale, gift, or otherwise. This warranty is not transferable and is only valid to the original purchaser.

This warranty is available only for purchases made within and the original purchaser currently residing in the USA and Canada. Please consult with your local distributor for warranty information specific to your region. The product must have been registered within 30 days of the original purchase date or supply proof of purchase to validate warranty (original sales invoice).

This warranty does not extend to any losses or damages due to accident, misuse, abuse, neglect, negligence, unauthorized modification or alteration, use beyond rated capacity, unsuitable power sources or environmental conditions, water, tampering, cosmetic damages, or improper installation, handling, repair, maintenance, or application, or lack of proper maintenance.

If the item exhibits such a defect, BODYCRAFT will, at its option, repair or replace it without cost for parts. Shipping and handling charges may apply. (BODYCRAFT may require return of the part(s) or photographic evidence of the damaged part(s) prior to replacement.) Serial number is required. Parts repaired or replaced will be warranted for the remainder of the original warranty period only.

Residential Warranty for Strength Equipment:

Frame: Lifetime, **Parts:** Lifetime

This warranty excludes the following:

1. The warranty does not cover normal maintenance or labor charges unless labor terms are listed above.
2. Normal cosmetic wear on parts such as paint, seat coverings, foot rails, labels and logos.
3. Any accessories not included in the original packaging.
4. Warranty does not cover normal wear and tear.

* This warranty is in lieu of all warranties, expressed or implied, and/or all other obligations or liabilities on our part, and we neither assume nor authorize any person to assume for us any other obligation or liability in connection with the sale of your BODYCRAFT product. Under no circumstances shall we be liable by virtue of this warranty or otherwise for damage to any person or property whatsoever for any special, indirect, incidental, secondary or consequential damage of any nature whatsoever arising out of the use or inability to use the BODYCRAFT product.

Register your product's warranty at www.bodycraft.com/product-registration.html

Warranty Registration - Strength

Thank you for purchasing a BODYCRAFT product. To validate the product warranty the fast and easy way, please go on-line now to <https://www.bodycraft.com/product-registration.html> and register your product. The information you provide will never be distributed to any other individuals or agencies for any purpose. If you prefer to mail your warranty card, have the owner of the product complete the information below and return it to BODYCRAFT within 30 days from the date of equipment installation.

Please Note: Failure to register this product will result in no servicing or authorization of parts to be shipped.

To mail your warranty information, please fill in the information below and mail to: Service Dept., BODYCRAFT, 7699 Green Meadows Dr. Lewis Center, Ohio 43035 (or save postage and register online at <https://www.bodycraft.com/product-registration.html>)

WARRANTY REGISTRATION

PLEASE PROVIDE BOTH SERIAL NUMBERS BELOW.
REQUIRED FOR WARRANTY REGISTRATION:

BASE UNIT SERIAL NUMBER:

OPTIONS SERIAL NUMBER:

Model Type: _____

Date of Purchase _____

Your Company Name _____

Contact First Name _____

Contact Last Name _____

Address _____

City _____ State _____ ZIP _____

Email Address _____ Website _____

Phone _____ Fax _____

1. Where did you first learn about BODYCRAFT?

- ☐ a. Dealer ☐ b. Website
☐ c. Advertisement ☐ d. Referral
☐ e. Current Customer ☐ f. Other _____

2. Why did you purchase a BODYCRAFT product?

- ☐ a. Design/Appearance ☐ b. Dealer Suggestion
☐ c. Price/Value ☐ d. Quality Construction
☐ e. Performance ☐ f. BODYCRAFT Reputation
☐ g. Other: _____

3. Please indicate your type of facility:

- ☐ a. Apartment/Condo ☐ b. Corporate Fitness Center
☐ c. Municipality ☐ d. Health Club/Gym/Spa
☐ e. Hotel/Resort ☐ f. Military Base
☐ g. Student Rec Center ☐ h. Home

4. What other types of equipment does your company or home currently own?

- ☐ a. Treadmill Brand _____
☐ b. Elliptical Brand _____
☐ c. Bike/Indoor Cycle Brand _____
☐ d. Free Weights/Gym Brand _____

5. How many people use your facility on a daily basis?

- ☐ a. <25 ☐ b. 25-75
☐ c. 76-150 ☐ d. 150+

6. Do you plan to purchase more fitness equipment in the next 6-12 months?

- ☐ Yes ☐ No

7. If you answered "yes" to question 6, what type do you plan to purchase?

- ☐ a. Treadmill ☐ b. Elliptical
☐ c. Bike/Indoor Cycle ☐ d. Free Weights
☐ e. Gym ☐ f. Other _____

8. Would you recommend BODYCRAFT to other club or home owners?

- ☐ Yes ☐ No

9. You are a valued BODYCRAFT customer and your suggestions allow us to continually improve your experience. Is there anything else you would like us to know? Please explain:



800.990.5556
SERVICE@BODYCRAFT.COM
WWW.BODYCRAFT.COM



BODYCRAFT
7699 GREEN MEADOWS DR.
LEWIS CENTER, OHIO 43035